

+NOTICE!!

These documents have been scanned!

Do not place un-scanned documents beneath this notice!

Do not remove this notice from this file!

GPO Jacket No. 560-102
Print Order 61549
Rise Business Services, LLC
Job=AZ15 9/11/2019



Box Number= AZ15234



Claim Begin-End: AMC450508-AMC450537

1 Initial Receipt



AZ15234-4

AMC448147-AMC457012

United States Department of the Interior
Bureau of Land Management
 DIV OF LANDS, MINRLS & ENERGY
 ONE N CENTRAL AVE
 PHOENIX, AZ 85004 -4427
 Phone: 602-417-9200

Receipt

No:

4144161

Transaction #: 4258050**Date of Transaction:** 04/23/2018

CUSTOMER:

NICK BARR
 5441 E MINING CAMP ST
 APACHE JUNCTION, AZ 85119-9577 US

ENTERED
 APR 26 2018
 BY: *Ripm*

LINE #	QTY	DESCRIPTION	REMARKS	UNIT PRICE	TOTAL
1	30.00	LOCATABLE MINERALS / MINING CLAIMS- NEW, UNADJUD, ONE OR MORE AUTH NOS / NEW MINING CLAIM PROCESSING FEE CASES: AMC450508/\$20.00, AMC450509/\$20.00, AMC450510/\$20.00, AMC450511/\$20.00, AMC450512/\$20.00, AMC450513/\$20.00, AMC450514/\$20.00, AMC450515/\$20.00, AMC450516/\$20.00, AMC450517/\$20.00, AMC450518/\$20.00, AMC450519/\$20.00, AMC450520/\$20.00, AMC450521/\$20.00, AMC450522/\$20.00, AMC450523/\$20.00, AMC450524/\$20.00, AMC450525/\$20.00, AMC450526/\$20.00, AMC450527/\$20.00, AMC450528/\$20.00, AMC450529/\$20.00, AMC450530/\$20.00, AMC450531/\$20.00, AMC450532/\$20.00, AMC450533/\$20.00, AMC450534/\$20.00, AMC450535/\$20.00, AMC450536/\$20.00, AMC450537/\$20.00		- n/a -	600.00
2	30.00	LOCATABLE MINERALS / MINING CLAIMS- NEW, UNADJUD, ONE OR MORE AUTH NOS / NEW MINING CLAIMS LOCATION FEE CASES: AMC450508/\$37.00, AMC450509/\$37.00, AMC450510/\$37.00, AMC450511/\$37.00, AMC450512/\$37.00, AMC450513/\$37.00, AMC450514/\$37.00, AMC450515/\$37.00, AMC450516/\$37.00, AMC450517/\$37.00, AMC450518/\$37.00, AMC450519/\$37.00, AMC450520/\$37.00, AMC450521/\$37.00, AMC450522/\$37.00, AMC450523/\$37.00, AMC450524/\$37.00, AMC450525/\$37.00, AMC450526/\$37.00, AMC450527/\$37.00,		- n/a -	1110.00

		AMC450528/\$37.00, AMC450529/\$37.00, AMC450530/\$37.00, AMC450531/\$37.00, AMC450532/\$37.00, AMC450533/\$37.00, AMC450534/\$37.00, AMC450535/\$37.00, AMC450536/\$37.00, AMC450537/\$37.00			
3	30.00	LOCATABLE MINERALS / MINING CLAIMS- NEW, UNADJUD, ONE OR MORE AUTH NOS / NEW MINING CLAIMS MAINTENANCE FEE CASES: AMC450508/\$155.00, AMC450509/\$155.00, AMC450510/\$155.00, AMC450511/\$155.00, AMC450512/\$155.00, AMC450513/\$155.00, AMC450514/\$155.00, AMC450515/\$155.00, AMC450516/\$155.00, AMC450517/\$155.00, AMC450518/\$155.00, AMC450519/\$155.00, AMC450520/\$155.00, AMC450521/\$155.00, AMC450522/\$155.00, AMC450523/\$155.00, AMC450524/\$155.00, AMC450525/\$155.00, AMC450526/\$155.00, AMC450527/\$155.00, AMC450528/\$155.00, AMC450529/\$155.00, AMC450530/\$155.00, AMC450531/\$155.00, AMC450532/\$155.00, AMC450533/\$155.00, AMC450534/\$155.00, AMC450535/\$155.00, AMC450536/\$155.00, AMC450537/\$155.00		- n/a -	4650.00
TOTAL:					\$6,360.00

PAYMENT INFORMATION				
1	AMOUNT:	6360.00	POSTMARKED:	N/A
	TYPE:	CHECK	RECEIVED:	04/19/2018
	CHECK NO:	6786103371		
	NAME:	BARR, NICK 5441 E MINING CAMP ST APACHE JUNCTION AZ 85119-9577 US		

REMARKS

This receipt was generated by the automated BLM Collections and Billing System and is a paper representation of a portion of the official electronic record contained therein.

NOTICE!!

These documents have been scanned!

Do not place un-scanned documents beneath this notice!

Do not remove this notice from this file!

GPO Jacket No. 560-102
Print Order 61549
Rise Business Services, LLC
Job=AZ15 9/11/2019



Box Number= AZ15234



Claim Begin-End: AMC450508-AMC450537

2 Correspondence



AZ15234-4

AMC448147-AMC457012

**NO
DOCUMENTS
FOUND**

NO DOCUMENTS FOUND
NO DOCUMENTS FOUND

NOTICE!!

These documents have been scanned!

Do not place un-scanned documents beneath this notice!

Do not remove this notice from this file!

GPO Jacket No. 560-102
Print Order 61549
Rise Business Services, LLC
Job=AZ15 9/11/2019



Box Number= AZ15234



Claim Begin-End: AMC450508-AMC450537

3 Transfers



AZ15234-4

AMC448147-AMC457012

**NO
DOCUMENTS
FOUND**

NO DOCUMENTS FOUND
NO DOCUMENTS FOUND

NOTICE!!

These documents have been scanned!

Do not place un-scanned documents beneath this notice!

Do not remove this notice from this file!

GPO Jacket No. 560-102
Print Order 61549
Rise Business Services, LLC
Job=AZ15 9/11/2019



Box Number= AZ15234



Claim Begin-End: AMC450508-AMC450537

4 Annual Filings



AZ15234-4

AMC448147-AMC457012

DEPARTMENT OF THE INTERIOR
BUREAU OF LAND MANAGEMENT
MINING CLAIMS

Run Date/Time: 8/20/2018

MC Maintenance Fees Paid Through the BLM Pay Portal
(by Date Paid)

Page 224 Of 316

CBS Receipt: 4236464

Printed For Lead File # **AMC450508**

Agency Tracking ID: 1534342537

Assessment Year: 2019

Paid On: 8/15/2018

Number of BLM Serial Nr: 60

Total Amount Paid: \$9,300.00

Claim Name	BLM Serial No	Lead File No	Amount Paid
EN #12	AMC439782	AMC439782	\$155.00
EN #13	AMC439783	AMC439782	\$155.00
EN #14	AMC439784	AMC439782	\$155.00
EN #15	AMC439785	AMC439782	\$155.00
EN #16	AMC439786	AMC439782	\$155.00
EN #17	AMC439787	AMC439782	\$155.00
EN #19	AMC439788	AMC439782	\$155.00
EN #20	AMC439789	AMC439782	\$155.00
EN #21	AMC439790	AMC439782	\$155.00
EN #22	AMC439791	AMC439782	\$155.00
EN #24	AMC439792	AMC439782	\$155.00
EN #25	AMC439793	AMC439782	\$155.00
EN #26	AMC439794	AMC439782	\$155.00
EN #27	AMC439795	AMC439782	\$155.00
EN #28	AMC439796	AMC439782	\$155.00
EN #29	AMC439797	AMC439782	\$155.00
EN 33	AMC450410	AMC450410	\$155.00
EN 34	AMC450411	AMC450410	\$155.00
EN 35	AMC450412	AMC450410	\$155.00
EN 36	AMC450413	AMC450410	\$155.00
EN 37	AMC450414	AMC450410	\$155.00
EN 38	AMC450415	AMC450410	\$155.00
EN 39	AMC450416	AMC450410	\$155.00
EN 40	AMC450417	AMC450410	\$155.00

NO WARRANTY IS MADE BY BLM FOR USE OF THE DATA FOR PURPOSES NOT INTENDED BY BLM

**DEPARTMENT OF THE INTERIOR
BUREAU OF LAND MANAGEMENT
MINING CLAIMS**

Run Date/Time: 8/20/2018

**MC Maintenance Fees Paid Through the BLM Pay Portal
(by Date Paid)**

Page 225 Of 316

EN 41	AMC450418	AMC450410	\$155.00
EN 42	AMC450419	AMC450410	\$155.00
EN 43	AMC450420	AMC450410	\$155.00
EN 44	AMC450421	AMC450410	\$155.00
53	AMC450508	AMC450508	\$155.00
55	AMC450509	AMC450508	\$155.00
57	AMC450510	AMC450508	\$155.00
59	AMC450511	AMC450508	\$155.00
61	AMC450512	AMC450508	\$155.00
63	AMC450513	AMC450508	\$155.00
65	AMC450514	AMC450508	\$155.00
67	AMC450515	AMC450508	\$155.00
69	AMC450516	AMC450508	\$155.00
71	AMC450517	AMC450508	\$155.00
73	AMC450518	AMC450508	\$155.00
75	AMC450519	AMC450508	\$155.00
77	AMC450520	AMC450508	\$155.00
79	AMC450521	AMC450508	\$155.00
81	AMC450522	AMC450508	\$155.00
82	AMC450523	AMC450508	\$155.00
83	AMC450524	AMC450508	\$155.00
84	AMC450525	AMC450508	\$155.00
85	AMC450526	AMC450508	\$155.00
86	AMC450527	AMC450508	\$155.00
87	AMC450528	AMC450508	\$155.00
89	AMC450529	AMC450508	\$155.00
88	AMC450530	AMC450508	\$155.00
90	AMC450531	AMC450508	\$155.00
91	AMC450532	AMC450508	\$155.00
92	AMC450533	AMC450508	\$155.00
93	AMC450534	AMC450508	\$155.00
94	AMC450535	AMC450508	\$155.00
95	AMC450536	AMC450508	\$155.00
96	AMC450537	AMC450508	\$155.00
EN 30	AMC450942	AMC450942	\$155.00

NO WARRANTY IS MADE BY BLM FOR USE OF THE DATA FOR PURPOSES NOT INTENDED BY BLM

DEPARTMENT OF THE INTERIOR
BUREAU OF LAND MANAGEMENT
MINING CLAIMS

Run Date/Time: 8/20/2018

MC Maintenance Fees Paid Through the BLM Pay Portal
(by Date Paid)

Page 226 Of 316

EN 31	AMC450943	AMC450942	\$155.00
-------	-----------	-----------	----------

United States Department of the Interior
Bureau of Land Management
 BUSINESS & SUPPORT SVCS DIV
 ONE N CENTRAL AVE SUITE 800
 PHOENIX, AZ 85004 -4427
 Phone: 602-417-9200

Receipt

No: 4236464

Transaction #: 4351836	
Date of Transaction: 08/15/2018	
CUSTOMER:	
	JOEL ADAMS 145 WEST 67TH # 33G NEW YORK, NY 10023 US

LINE #	QTY	DESCRIPTION	REMARKS	UNIT PRICE	TOTAL
1	1.00	LOCATABLE MINERALS / MINING CLAIMS- NOT NEW-UNADJUD, ONE AUTH NO. ONLY / MINING CLAIM MONEY RECEIVED CASES: AMC439782/\$9300.00		- n/a -	9300.00
TOTAL:					\$9,300.00

PAYMENT INFORMATION			
NOTE: Items will appear on credit card statement as "BLM O Mining Claim".			
1	AMOUNT:	9300.00	POSTMARKED: N/A
	TYPE:	CREDIT CARD	RECEIVED: 08/15/2018
	NAME:	JOEL ADAMS 145 WEST 67TH # 33G NEW YORK NY 10023 US	
	CARD NO:	XXXXXXXXXXXX2270	AUTH CODE: 006064
	NAME ON CARD:	JOEL ADAMS	
	SIGNATURE:		

REMARKS

This receipt was generated by the automated BLM Collections and Billing System and is a paper representation of a portion of the official electronic record contained therein.

NOTICE!!

These documents have been scanned!

Do not place un-scanned documents beneath this notice!

Do not remove this notice from this file!

GPO Jacket No. 560-102
Print Order 61549
Rise Business Services, LLC
Job=AZ15 9/11/2019



Box Number= AZ15234



Claim Begin-End: AMC450508-AMC450537

5 Miscellaneous



AZ15234-4

AMC448147-AMC457012

April 16, 2018

US Department of the Interior
Bureau of Land Management
1 North Central Avenue
Suite 800
Phoenix, AZ 85004

2018 APR 19 P 1:11
RECEIVED, BLM PHOENIX

Dear Sir/Madam

Please see enclosed the documentation, including maps, for thirty, (30), lode mining claims located on January 21st 2018 and filed and recorded by Mohave County on February 08, 2018 for Pershing Resources Company. All 30 lode mining claims were located, dated and, posted by Nick Barr, acting as agent for Pershing Resources Company.

Also enclosed is a return envelope and a cashier's check to the BLM/US Department of the Interior for \$6360.00 to cover the filing and initial maintenance fees for the 30 lode mining claims at \$212.00 per claim filed/recorded.

The 30 Lode Mining Claims for BLM recordation are;

Mohave # 53, 55, 57, 59, 61, 63, 65, 67, 69, 71, 73, 75, 77, 79, 81, 82, 83, 84, 85, 86, 87, 89, 88, 90, 91, 92, 93, 94, 95, 96

Please contact me directly if there is any information that is missing or requires further explanation.
Thank you for your attention to this matter.

Kind regards,

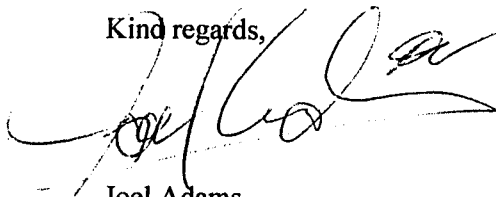

Joel Adams
Chief Operating Officer
Director and Corporate Secretary
Pershing Resources Company
200 South Virginia Street 8th Floor
Reno, Nevada 89501
jadams@pershingpm.com
646 387 6859 (cell)

NOTICE!!

These documents have been scanned!

Do not place un-scanned documents beneath this notice!

Do not remove this notice from this file!

GPO Jacket No. 560-102
Print Order 61549
Rise Business Services, LLC
Job=AZ15 9/11/2019



Box Number= AZ15234



Claim Begin-End: AMC450508-AMC450537

6 Location Notices-Amendments and Supporting Documents



AZ15234-4 AMC448147-AMC457012

MINING CLAIM STATUS REPORT

Data Entered: 4/26/18 AM

MTP Checked By: 4/26/18 AM
GEO Checked By: 4/26/18 AM

LEAD SERIAL NUMBER: AMC 450508 thru AMC 450537

NUMBER OF CLAIMS & TYPE:

30 LODE
PLACER
ASSOCIATION PLACER
MILL SITE
TUNNEL SITE

CHARGES:

Processing Fee @ \$20 = \$ 600
Location Fee @ \$37 = \$ 1,110
Maintenance Fee @ \$155 = \$ 4,650
Add'l Maint Fee for Assoc Placer = \$
SUBTOTAL \$
Other Fees \$
Other Fees \$
TOTAL \$ 6,360

TOTAL ACREAGE: _____ Per Claim
(Placer Only)

NUMBER OF LOCATORS: _____

DOCUMENTS RECEIVED VIA: Over-the-Counter [] Mail [X] TIMELY FILED: Yes [X] No []

LEGAL DESCRIPTION:

T 20N R 14W SEC
T 20N R 15W SEC
T _____ R _____ SEC
T _____ R _____ SEC
T _____ R _____ SEC

18, 19, 12

BLM [] FOREST SERVICE [] SUBJ TO PL 359: Yes [] No []
WILDERNESS AREA []

SPLIT ESTATE: N/A [] SX [] PX [] OTHER []
SRHA [] Was proper Notice filed if located on SHRA Land? Yes [] No []

RECONVEYED MINERALS ON BLM LAND REQUIRE OPENING ORDER FROM 1944 TO 1993:

Open to Entry On _____ N/A []

COMMENTS/STATUS: VOID [] PARTIALLY VOID [] PVT MINERALS [] WITHDRAWN LANDS []
OTHER []

AMC 450508

[] Claimant acknowledges that portions of the following claim(s) site(s) may be void or voidable.

Printed Name of Claimant _____

Signature of Claimant _____

*****FINAL ADJUDICATION*****

DATE _____

INITIALS _____

After recording return to:

Pershing Resources
200 S. Virginia St., 8th Floor
Reno, Nevada 89501

FEE# 2018006147

OFFICIAL RECORDS
OF MOHAVE COUNTY
KRISTI BLAIR,
COUNTY RECORDER



02/08/2018 11:24 AM Fee: \$10.00

PAGE: 1 of 2

LOCATION NOTICE for LODE MINING CLAIM

Notice Is Hereby Given that the Mohave # 53
lode mining claim has been located by Nick Barr
whose current mailing address is; 5441 E. Mining
Apache Junction, Arizona 85119 Camp St.

BLM
date
stamp

2018 APR 19 P 1:11
MOHAVE COUNTY, ARIZONA

The general course of this claim is EAST-WEST, and is situated in Mohave County, AZ. This claim is 1500 feet in length and 600 feet in width. This claim runs from the location monument, on which this location notice is posted, approximately 1480 feet in a WEST direction to the west end line and 20 feet in an EAST direction to the East end line. This claim is marked by six monuments, one at each corner and one at the center of each end line of the claim.

The location monument on which this notice is posted is situated within Section 18 Township 20 North, Range 14 West, Gila Salt River Base and Meridian, Arizona and this claim encompasses portions of the following quarter sections (s), Township (s), and Range (s) NW 1/4 NE 1/4 Section 18 T.20N. R.14E Township 20 North, Range 14 West, Gila Salt River Base and Meridian, AZ.

The locality of this claim, with reference to some natural object or permanent monument and additional information (if any) concerning its locality are as follows:

The Southwest corner of claim is located 2300 feet EAST and 4650 feet NORTH of a brass cap permanent survey monument located at the south ~~west~~ corner of Section 18 Township 20 North, Range 14 West, GSRB&M

DATED and POSTED on the ground this 21 day of

January, 2018

LOCATOR Nick Barr
Nick Barr
Agent for: Pershing Resources
200 S. Virginia St. 8th Floor
Reno, Nevada 89501

AHC450508

MINING CLAIM MAP

Lode (X) Placer ()

← 1 mile →

12

R 15 W
R 14 W

7

13

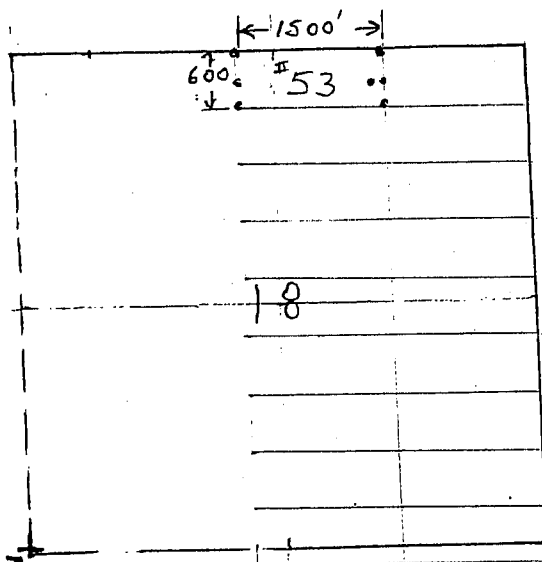

CLAIM SURVEY TIE
MONUMENT

24

19

Scale: 1" = 2000 feet

1 N

1. The above map depicts the Mohave # 53 mining claim, which is located in Section (s) 18, Township 20 North, Range (s), 14, West, Gila and Salt River Base and Meridian, Mohave County, Arizona.
2. The type of corner and location monuments used are as follows
2" x 2" x 4 ft wooden posts
3. The bearings and distances in degrees and feet between claim corners are as depicted on the map.

After recording return to:

Pershing Resources
200 S. Virginia St., 8th Floor
Reno, Nevada 89501

FEE# 2018006149

OFFICIAL RECORDS
OF MOHAVE COUNTY
KRISTI BLAIR,
COUNTY RECORDER



02/08/2018 11:24 AM Fee: \$10.00

PAGE: 1 of 2

LOCATION NOTICE for LODE MINING CLAIM

Notice Is Hereby Given that the Mohave # 55
lode mining claim has been located by Nick Barr
whose current mailing address is; 5441 E. Mining
Apache Junction, Arizona 85119 Camp St.

BLM
date
stamp

2018 APR 19 P 1:1
M. ENX. ANIZCH

The general course of this claim is EAST-WEST, and is situated in Mohave County, AZ. This claim is 1500 feet in length and 600 feet in width. This claim runs from the location monument, on which this location notice is posted, approximately 1480 feet in a WEST direction to the west end line and 20 feet in an EAST direction to the East end line. This claim is marked by six monuments, one at each corner and one at the center of each end line of the claim.

The location monument on which this notice is posted is situated within Section 18 Township 20 North, Range 14 West, Gila Salt River Base and Meridian, Arizona and this claim encompasses portions of the following quarter sections (s), Township (s), and Range (s) NE 1/4 NW 1/4 Section 18
Township 20 North, Range 14 West, Gila Salt River Base and Meridian, AZ.

The locality of this claim, with reference to some natural object or permanent monument and additional information (if any) concerning its locality are as follows:

The Southwest corner of claim is located 2300 feet EAST and 4050 feet NORTH of a brass cap permanent survey monument located at the southwest corner of Section 18 Township 20 North, Range 14 West, GSRB&M

DATED and POSTED on the ground this 21 day of

JANUARY, 2018

LOCATOR

Nick Barr

Nick Barr
Agent for: Pershing Resources
200 S. Virginia St. 8th Floor
Reno, Nevada 89501

AHC450509

MINING CLAIM MAP

Lode (X) Placer ()

← 1 mile →

12

R 15 W
R 14 W

7

13

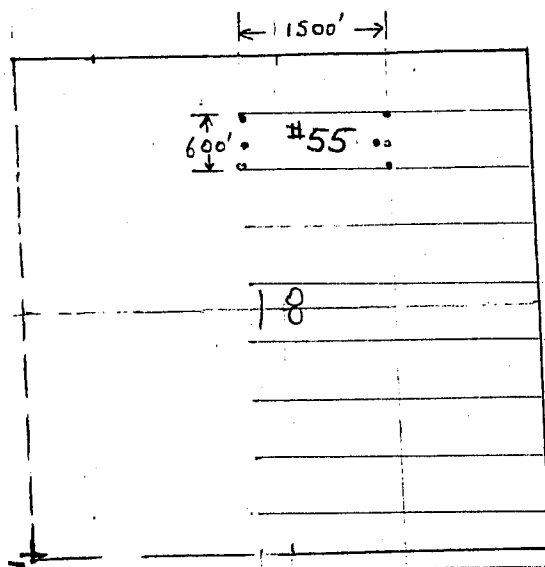

CLAIM SURVEY TIE
MONUMENT

24

Scale: 1" = 2000 feet

↑ N

1. The above map depicts the Mohave # 55 mining claim, which is located in Section (s) 18, Township 20 North, Range (s), 14, West, Gila and Salt River Base and Meridian, Mohave County, Arizona.
2. The type of corner and location monuments used are as follows
2" x 2" x 4 ft wooden posts
3. The bearings and distances in degrees and feet between claim corners are as depicted on the map.

After recording return to:

Pershing Resources
200 S. Virginia St., 8th Floor
Reno, Nevada 89501

FEE# 2018006151

OFFICIAL RECORDS
OF MOHAVE COUNTY
KRISTI BLAIR,
COUNTY RECORDER



02/08/2018 11:24 AM Fee: \$10.00

PAGE: 1 of 2

LOCATION NOTICE for LODGE MINING CLAIM

Notice Is Hereby Given that the Mohave # 57
lode mining claim has been located by Nick Barr
whose current mailing address is: 5441 E. Mining
Apache Junction, Arizona 85119 Camp St.

BLM
date
stamp

2018 APR 19 P 1:
MOHAVE COUNTY, ARIZONA

The general course of this claim is EAST-WEST, and is situated in Mohave County, AZ. This claim is 1500 feet in length and 600 feet in width. This claim runs from the location monument, on which this location notice is posted, approximately 1480 feet in a WEST direction to the west end line and 20 feet in an EAST direction to the East end line. This claim is marked by six monuments, one at each corner and one at the center of each end line of the claim.

The location monument on which this notice is posted is situated within Section 18 Township 20 North, Range 14 West, Gila Salt River Base and Meridian, Arizona and this claim encompasses portions of the following quarter sections (s), Township (s), and Range (s) NW 1/4 NE 1/4 Section 18 Township 20 North, Range 14 West, Gila Salt River Base and Meridian, AZ.

The locality of this claim, with reference to some natural object or permanent monument and additional information (if any) concerning its locality are as follows:

The Southwest corner of claim is located 2300 feet EAST and 3450 feet NORTH of a brass cap permanent survey monument located at the southwest corner of Section 18 Township 20 North, Range 14 West, GSRB&M

DATED and POSTED on the ground this 21 day of

JANUARY, 2018

LOCATOR Nick Barr

Nick Barr
Agent for: Pershing Resources
200 S. Virginia St. 8th Floor
Reno, Nevada 89501

AHC450510

MINING CLAIM MAP

Lode (X) Placer ()

← 1 mile →

12

R15W
R14W

7

13

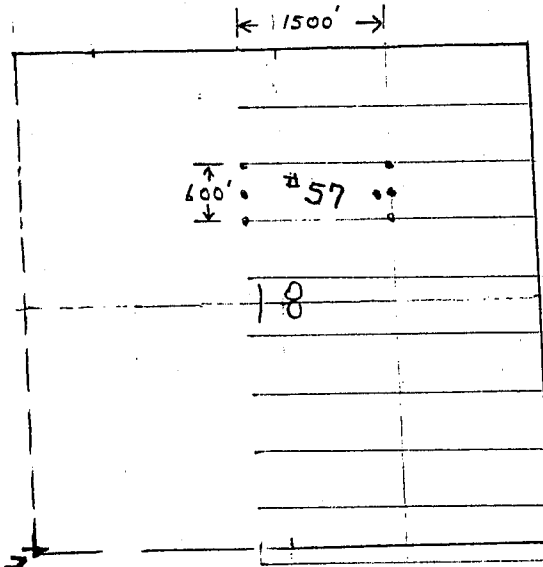

CLAIM SURVEY TIE
MONUMENT

24

19

Scale: 1" = 2000 feet

↑ N

1. The above map depicts the Mohave # 57 mining claim, which is located in Section (s) 18, Township 20 North, Range (s), 14, West, Gila and Salt River Base and Meridian, Mohave County, Arizona.
2. The type of corner and location monuments used are as follows:
2" x 2" x 4 ft wooden posts.
3. The bearings and distances in degrees and feet between claim corners are as depicted on the map.

After recording return to:

Pershing Resources
200 S. Virginia St., 8th Floor
Reno, Nevada 89501

FEE# 2018006153

OFFICIAL RECORDS
OF MOHAVE COUNTY
KRISTI BLAIR,
COUNTY RECORDER



02/08/2018 11:24 AM Fee: \$10.00

PAGE: 1 of 2

LOCATION NOTICE for LODE MINING CLAIM

Notice Is Hereby Given that the Mohave # 59
lode mining claim has been located by Nick Barr
whose current mailing address is: 5441 E. Mining
Apache Junction, Arizona 85119 Camp St.

BLM
date
stamp

2018 APR 19 P 1:
PHOENIX, ARIZONA

The general course of this claim is EAST-WEST, and is situated in Mohave County, AZ. This claim is 1500 feet in length and 600 feet in width. This claim runs from the location monument, on which this location notice is posted, approximately 1480 feet in a WEST direction to the west end line and 20 feet in an EAST direction to the East end line. This claim is marked by six monuments, one at each corner and one at the center of each end line of the claim.

The location monument on which this notice is posted is situated within Section 18 Township 20 North, Range 14 West, Gila Salt River Base and Meridian, Arizona and this claim encompasses portions of the following quarter sections (s), Township (s), and Range (s) NE & NW 1/4 Section 18 Township 20 North, Range 14 West, Gila Salt River Base and Meridian, AZ.

The locality of this claim, with reference to some natural object or permanent monument and additional information (if any) concerning its locality are as follows:

The Southwest corner of claim is located 2300 feet EAST and 2850 feet NORTH of a brass cap permanent survey monument located at the southwest corner of Section 18 Township 20 North, Range 14 West, GSRB&M

DATED and POSTED on the ground this 21 day of

January, 2018

LOCATOR Nick Barr

Nick Barr
Agent for: Pershing Resources
200 S. Virginia St. 8th Floor
Reno, Nevada 89501

AHC450511

MINING CLAIM MAP

Lode (X) Placer ()

← 1 mile →

12

R15W
R14W

7

13

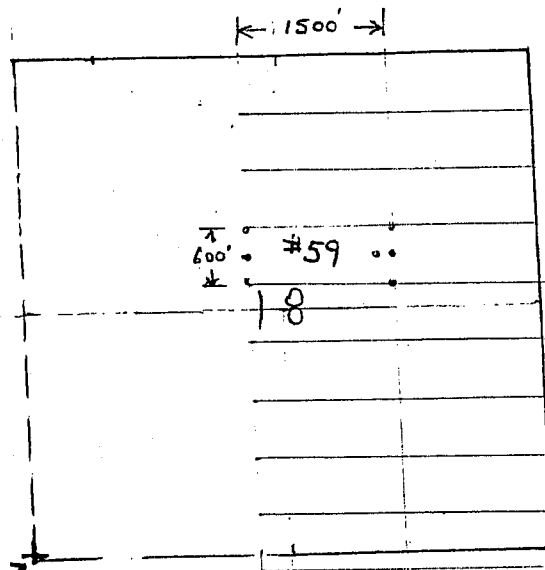

CLAIM SURVEY TIE
MONUMENT

24

19

Scale: 1" = 2000 feet

↑ N

1. The above map depicts the Mohave # 59 mining claim, which is located in Section (s) 18, Township 20 North, Range (s), 14 West, Gila and Salt River Base and Meridian, Mohave County, Arizona.
2. The type of corner and location monuments used are as follows:
2" x 2" x 4 ft wooden posts.
3. The bearings and distances in degrees and feet between claim corners are as depicted on the map.

After recording return to:

Pershing Resources
200 S. Virginia St., 8th Floor
Reno, Nevada 89501

FEE# 2018006155

OFFICIAL RECORDS
OF MOHAVE COUNTY
KRISTI BLAIR,
COUNTY RECORDER



02/08/2018 11:24 AM Fee: \$10.00

PAGE: 1 of 2

LOCATION NOTICE for LODE MINING CLAIM

Notice Is Hereby Given that the Mohave # 61
lode mining claim has been located by Nick Barr
whose current mailing address is; 5441 E. Mining
Apache Junction, Arizona 85119 Camp St.

BLM
date
stamp

2018 APR 19 P 1:17
MOHAVE COUNTY, ARIZONA

The general course of this claim is EAST-WEST, and is situated in Mohave County, AZ. This claim is 1500 feet in length and 600 feet in width. This claim runs from the location monument, on which this location notice is posted, approximately 1480 feet in a WEST direction to the west end line and 20 feet in an EAST direction to the East end line. This claim is marked by six monuments, one at each corner and one at the center of each end line of the claim.

The location monument on which this notice is posted is situated within Section 18 Township 20 North, Range 14 West, Gila Salt River Base and Meridian, Arizona and this claim encompasses portions of the following quarter sections (s), Township (s), and Range (s) NE NW SE & SW 1/4 Section 18 Township 20 North, Range 14 West, Gila Salt River Base and Meridian, AZ.

The locality of this claim, with reference to some natural object or permanent monument and additional information (if any) concerning its locality are as follows:

The Southwest corner of claim is located 2300 feet EAST and 2250 feet NORTH of a brass cap permanent survey monument located at the south ~~west~~ corner of Section 18 Township 20 North, Range 14 West, GSRB&M

DATED and POSTED on the ground this 21 day of

January, 2018

LOCATOR

Nick Barr

Nick Barr
Agent for: Pershing Resources
200 S. Virginia St. 8th Floor
Reno, Nevada 89501

AHC450512

MINING CLAIM MAP

Lode (X) Placer ()

← 1 mile →

R 15 W
R 14 W

7

12

13

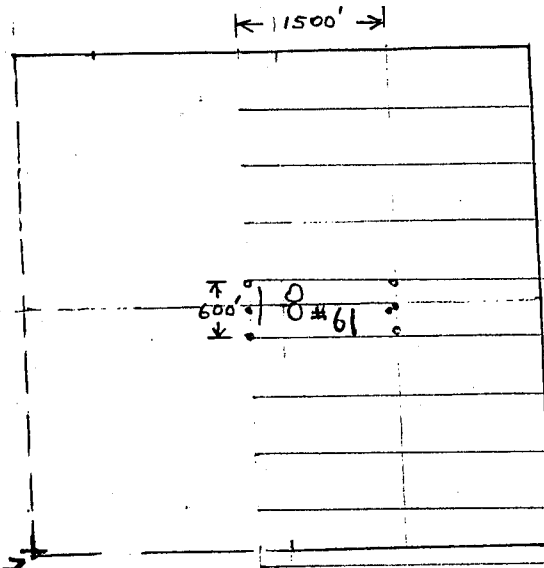

CLAIM SURVEY TIE
MONUMENT

24

19

Scale: 1" = 2000 feet

↑ N

1. The above map depicts the Mohave # 61 mining claim, which is located in Section (s) 18, Township 20 North, Range (s), 14, West, Gila and Salt River Base and Meridian, Mohave County, Arizona.
2. The type of corner and location monuments used are as follows:
2" x 2" x 4 ft wooden posts
3. The bearings and distances in degrees and feet between claim corners are as depicted on the map.

After recording return to:

Pershing Resources
200 S. Virginia St., 8th Floor
Reno, Nevada 89501

FEE# 2018006157

OFFICIAL RECORDS
OF MOHAVE COUNTY
KRISTI BLAIR,
COUNTY RECORDER



02/08/2018 11:24 AM Fee: \$10.00

PAGE: 1 of 2

LOCATION NOTICE for LODGE MINING CLAIM

Notice Is Hereby Given that the Mohave # 63
lode mining claim has been located by Nick Barr
whose current mailing address is; 5441 E. Mining
Apache Junction, Arizona 85119 Camp St.

BLM
date
stamp

2018 APR 19 P
PHOENIX, ARIZONA

The general course of this claim is EAST-WEST, and is situated in Mohave County, AZ. This claim is 1500 feet in length and 600 feet in width. This claim runs from the location monument, on which this location notice is posted, approximately 1480 feet in a WEST direction to the west end line and 20 feet in an EAST direction to the East end line. This claim is marked by six monuments, one at each corner and one at the center of each end line of the claim.

The location monument on which this notice is posted is situated within Section 18 Township 20 North, Range 14 West, Gila Salt River Base and Meridian, Arizona and this claim encompasses portions of the following quarter sections (s), Township (s), and Range (s) SE 1 SW 14 Section 18
Township 20 North, Range 14 West, Gila Salt River Base and Meridian, AZ.

The locality of this claim, with reference to some natural object or permanent monument and additional information (if any) concerning its locality are as follows:

The Southwest corner of claim is located 2300 feet EAST and 1650 feet NORTH of a brass cap permanent survey monument located at the southwest corner of Section 18 Township 20 North, Range 14 West, GSRB&M

DATED and POSTED on the ground this 21 day of

JANUARY, 2018

LOCATOR

Nick Barr

Nick Barr
Agent for: Pershing Resources
200 S. Virginia St. 8th Floor
Reno, Nevada 89501

AHC450513

MINING CLAIM MAP

Lode (X) Placer ()

← 1 mile →

12

R15 W
R14 W

7

13

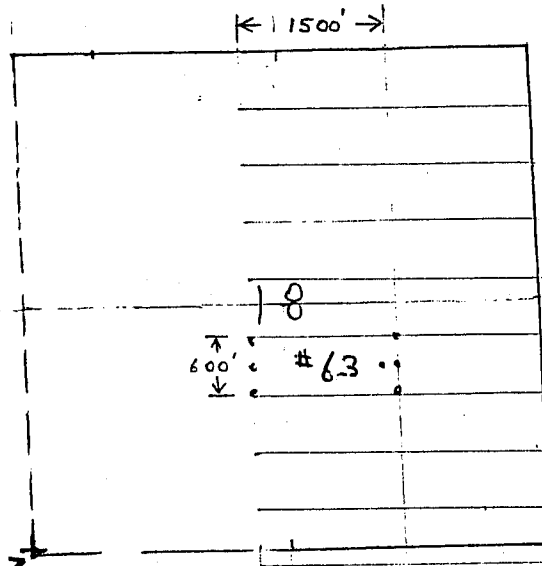

CLAIM SURVEY TIE
MONUMENT

24

19

Scale: 1" = 2000 feet

↑ N

1. The above map depicts the Mohave # 63 mining claim, which is located in Section (s) 18 Township 20 North, Range (s), 14 West, Gila and Salt River Base and Meridian, Mohave County, Arizona.
2. The type of corner and location monuments used are as follows:
2" x 2" x 4 ft wooden posts
3. The bearings and distances in degrees and feet between claim corners are as depicted on the map.

After recording return to:

Pershing Resources
200 S. Virginia St., 8th Floor
Reno, Nevada 89501

FEE# 2018006159

OFFICIAL RECORDS
OF MOHAVE COUNTY
KRISTI BLAIR,
COUNTY RECORDER



02/08/2018 11:24 AM Fee: \$10.00

PAGE: 1 of 2

LOCATION NOTICE for LODE MINING CLAIM

Notice Is Hereby Given that the Mohave # 65
lode mining claim has been located by Nick Barr
whose current mailing address is: 5441 E. Mining
Apache Junction, Arizona 85119 Camp St.

BLM
date
stamp

2018 APR 19 P
PHOENIX, ARIZONA

The general course of this claim is EAST-WEST, and is situated in Mohave County, AZ. This claim is 1500 feet in length and 600 feet in width. This claim runs from the location monument, on which this location notice is posted, approximately 1480 feet in a WEST direction to the west end line and 20 feet in an EAST direction to the East end line. This claim is marked by six monuments, one at each corner and one at the center of each end line of the claim.

The location monument on which this notice is posted is situated within Section 18 Township 20 North, Range 14 West, Gila Salt River Base and Meridian, Arizona and this claim encompasses portions of the following quarter sections (s), Township (s), and Range (s) SW 1 SE 1/4 Section 18 Township 20 North, Range 14 West, Gila Salt River Base and Meridian, AZ.

The locality of this claim, with reference to some natural object or permanent monument and additional information (if any) concerning its locality are as follows:

The Southwest corner of claim is located 2300 feet EAST and 1050 feet NORTH of a brass cap permanent survey monument located at the southwest corner of Section 18 Township 20 North, Range 14 West, GSRB&M

DATED and POSTED on the ground this 21 day of

January, 2018

LOCATOR

Nick Barr

Nick Barr
Agent for: Pershing Resources
200 S. Virginia St. 8th Floor
Reno, Nevada 89501

AHC450514

MINING CLAIM MAP

Lode (X) Placer ()

← 1 mile →

12

R 15 W
R 14 W

7

13

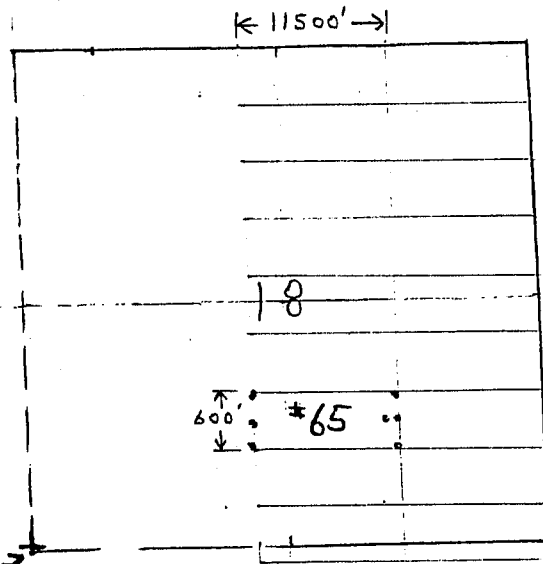

CLAIM SURVEY TIE
MONUMENT

24

19

Scale: 1" = 2000 feet

1 N

1. The above map depicts the Mohave # 65 mining claim, which is located in Section (s) 18, Township 20 North, Range (s), 14, West, Gila and Salt River Base and Meridian, Mohave County, Arizona.
2. The type of corner and location monuments used are as follows
2" x 2" x 4 ft wooden posts.
3. The bearings and distances in degrees and feet between claim corners are as depicted on the map.

2

After recording return to:

Pershing Resources
200 S. Virginia St., 8th Floor
Reno, Nevada 89501

FEE# 2018006161

OFFICIAL RECORDS
OF MOHAVE COUNTY
KRISTI BLAIR,
COUNTY RECORDER



02/08/2018 11:24 AM Fee: \$10.00

PAGE: 1 of 2

LOCATION NOTICE for LODGE MINING CLAIM

Notice Is Hereby Given that the Mohave # 67
lode mining claim has been located by Nick Barr
whose current mailing address is; 5441 E. Mining
Apache Junction, Arizona 85119 Camp St.

BLM
date
stamp

RECEIVED
2018 APR 19 P 1:11
MOHAVE COUNTY, ARIZONA

The general course of this claim is EAST-WEST, and is situated in Mohave County, AZ. This claim is 1500 feet in length and 600 feet in width. This claim runs from the location monument, on which this location notice is posted, approximately 1480 feet in a WEST direction to the west end line and 20 feet in an EAST direction to the East end line. This claim is marked by six monuments, one at each corner and one at the center of each end line of the claim.

The location monument on which this notice is posted is situated within Section 18 Township 20 North, Range 14 West, Gila Salt River Base and Meridian, Arizona and this claim encompasses portions of the following quarter sections (s), Township (s), and Range (s) SW 1/4 SE 1/4 Section 18
Township 20 North, Range 14 West, Gila Salt River Base and Meridian, AZ.

The locality of this claim, with reference to some natural object or permanent monument and additional information (if any) concerning its locality are as follows:

The Southwest corner of claim is located 2300 feet EAST and 450 feet NORTH of a brass cap permanent survey monument located at the southwest corner of Section 18 Township 20 North, Range 14 West, GSRB&M

DATED and POSTED on the ground this 21 day of

JANUARY, 2018

LOCATOR

Nick Barr

Nick Barr
Agent for: Pershing Resources
200 S. Virginia St. 8th Floor
Reno, Nevada 89501

AHC450515

MINING CLAIM MAP

Lode (X) Placer ()

← 1 mile →

12

R15W
R14W

7

13

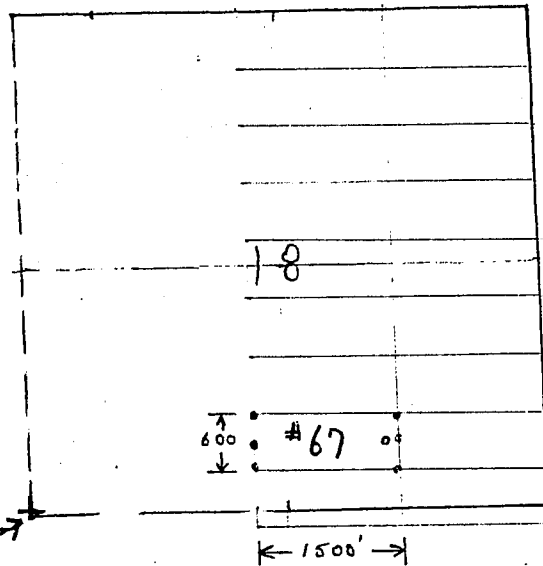

CLAIM SURVEY TIE
MONUMENT

24

19

Scale: 1" = 2000 feet

↑ N

1. The above map depicts the Mohave # 67 mining claim, which is located in Section (s) 18 Township 20 North, Range (s), 14 West, Gila and Salt River Base and Meridian, Mohave County, Arizona.
2. The type of corner and location monuments used are as follows:
2" x 2" x 4 ft wooden posts.
3. The bearings and distances in degrees and feet between claim corners are as depicted on the map.

After recording return to:

Pershing Resources
200 S. Virginia St., 8th Floor
Reno, Nevada 89501

FEE# 2018006163

OFFICIAL RECORDS
OF MOHAVE COUNTY
KRISTI BLAIR,
COUNTY RECORDER



02/08/2018 11:24 AM Fee: \$10.00

PAGE: 1 of 2

LOCATION NOTICE for LODE MINING CLAIM

Notice Is Hereby Given that the Mohave # 69
lode mining claim has been located by Nick Barr
whose current mailing address is: 5441 E. Mining
Apache Junction, Arizona 85119 Camp St.

BLM
date
stamp

2018 APR 19 P 1:
TUCSEN, ARIZONA

The general course of this claim is EAST-WEST, and is situated in Mohave County, AZ. This claim is 1500 feet in length and 600 feet in width. This claim runs from the location monument, on which this location notice is posted, approximately 1480 feet in a WEST direction to the west end line and 20 feet in an EAST direction to the East end line. This claim is marked by six monuments, one at each corner and one at the center of each end line of the claim.

The location monument on which this notice is posted is situated within Section 18 Township 20 North, Range 14 West, Gila Salt River Base and Meridian, Arizona and this claim encompasses portions of the following quarter sections (s), Township (s), and Range (s) SE 1/4 SW 1/4 Section 18 NE 1/4 NW 1/4 Section 19 Township 20 North, Range 14 West, Gila Salt River Base and Meridian, AZ.

The locality of this claim, with reference to some natural object or permanent monument and additional information (if any) concerning its locality are as follows:

The Southwest corner of claim is located 2300 feet EAST and 150 feet SOUTH of a brass cap permanent survey monument located at the southwest corner of Section 18 Township 20 North, Range 14 West, GSRB&M

DATED and POSTED on the ground this 21 day of

JANUARY, 2018

LOCATOR

Nick Barr
Agent for:

Nick Barr
Pershing Resources
200 S. Virginia St. 8th Floor
Reno, Nevada 89501

AHC450516

MINING CLAIM MAP

Lode (X) Placer ()

← 1 mile →

12

R 15 W
R 14 W

7

13

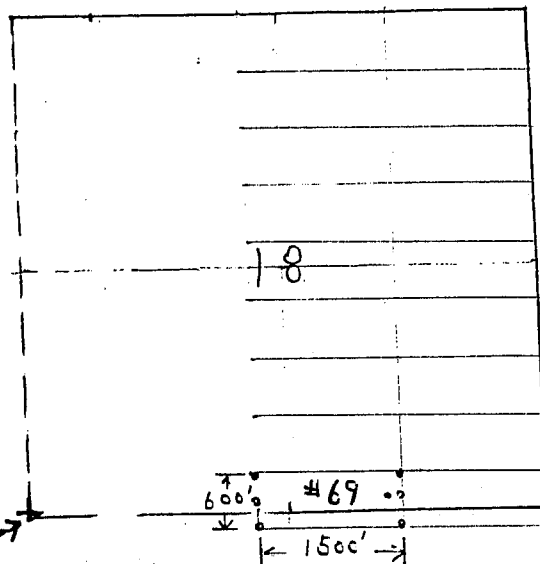

600' 1500'

CLAIM SURVEY TIE
MONUMENT

24

19

Scale: 1" = 2000 feet

↑ N

1. The above map depicts the Mohave # 69 mining claim, which is located in Section (s) 18 & 19, Township 20 North, Range (s), 14, West, Gila and Salt River Base and Meridian, Mohave County, Arizona.
2. The type of corner and location monuments used are as follows:
2" x 2" x 4 ft wooden posts.
3. The bearings and distances in degrees and feet between claim corners are as depicted on the map.

After recording return to:

Pershing Resources
200 S. Virginia St., 8th Floor
Reno, Nevada 89501

FEE# 2018006165

OFFICIAL RECORDS
OF MOHAVE COUNTY
KRISTI BLAIR,
COUNTY RECORDER



02/08/2018 11:24 AM Fee: \$10.00

PAGE: 1 of 2

LOCATION NOTICE for LODE MINING CLAIM

Notice Is Hereby Given that the Mohave # 71
lode mining claim has been located by Nick Barr
whose current mailing address is: 5441 E. Mining
Apache Junction, Arizona 85119 Camp St.

BLM
date
stamp

2018 APR 19 P 1:17
PHOENIX, ARIZONA

The general course of this claim is EAST-WEST, and is situated in Mohave County, AZ. This claim is 1500 feet in length and 600 feet in width. This claim runs from the location monument, on which this location notice is posted, approximately 1480 feet in a WEST direction to the west end line and 20 feet in an EAST direction to the East end line. This claim is marked by six monuments, one at each corner and one at the center of each end line of the claim.

The location monument on which this notice is posted is situated within Section 19 Township 20 North, Range 14 West, Gila Salt River Base and Meridian, Arizona and this claim encompasses portions of the following quarter sections (s), Township (s), and Range (s) NE 1/4, NW 1/4 Section 19 Township 20 North, Range 14 West, Gila Salt River Base and Meridian, AZ.

The locality of this claim, with reference to some natural object or permanent monument and additional information (if any) concerning its locality are as follows:

The Southwest corner of claim is located 2300 feet EAST and 750 feet SOUTH of a brass cap permanent survey monument located at the southwest corner of Section 18 Township 20 North, Range 14 West, GSRB&M

DATED and POSTED on the ground this 21 day of

JANUARY, 2018

LOCATOR

Nick Barr
Agent for:

Nick Barr
Pershing Resources
200 S. Virginia St. 8th Floor
Reno, Nevada 89501

AHC450517

MINING CLAIM MAP

Lode (X) Placer ()

← 1 mile →

13

R 15 W
R 14 W

18

claim survey tie monument

24

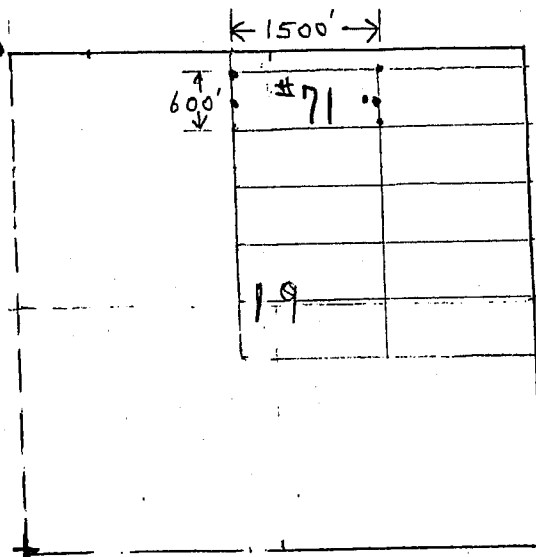

20

Scale: 1" = 2000 feet

↑ N

1. The above map depicts the Mohave # 71 mining claim, which is located in Section (s) 19, Township 20 North, Range (s), 14 West, Gila and Salt River Base and Meridian, Mohave County, Arizona.
2. The type of corner and location monuments used are as follows:
2" x 2" x 4 ft wooden posts.
3. The bearings and distances in degrees and feet between claim corners are as depicted on the map.

After recording return to:

Pershing Resources
200 S. Virginia St., 8th Floor
Reno, Nevada 89501

FEE# 2018006167

OFFICIAL RECORDS
OF MOHAVE COUNTY
KRISTI BLAIR,
COUNTY RECORDER



02/08/2018 11:24 AM Fee: \$10.00

PAGE: 1 of 2

LOCATION NOTICE for LODE MINING CLAIM

Notice Is Hereby Given that the Mohave # 73
lode mining claim has been located by Nick Barr
whose current mailing address is; 5441 E. Mining
Apache Junction, Arizona 85119 Camp St.

BLM
date
stamp

PHOENIX, ARIZONA

2018 APR 19 P 1:18

The general course of this claim is EAST-WEST, and is situated in Mohave County, AZ. This claim is 1500 feet in length and 600 feet in width. This claim runs from the location monument, on which this location notice is posted, approximately 1480 feet in a WEST direction to the west end line and 20 feet in an EAST direction to the East end line. This claim is marked by six monuments, one at each corner and one at the center of each end line of the claim.

The location monument on which this notice is posted is situated within Section 14 Township 20 North, Range 14 West, Gila Salt River Base and Meridian, Arizona and this claim encompasses portions of the following quarter sections (s), Township (s), and Range (s) NW & NE 1/4 Section 19 Township 20 North, Range 14 West, Gila Salt River Base and Meridian, AZ.

The locality of this claim, with reference to some natural object or permanent monument and additional information (if any) concerning its locality are as follows:

The Southwest corner of claim is located 3800 feet EAST and 1350 feet SOUTH of a brass cap permanent survey monument located at the southwest corner of Section 18 Township 20 North, Range 14 West, GSRB&M

DATED and POSTED on the ground this 21 day of

JANUARY, 2018

LOCATOR

Nick Barr

Nick Barr
Agent for: Pershing Resources
200 S. Virginia St. 8th Floor
Reno, Nevada 89501

AHC450518

MINING CLAIM MAP

Lode (X) Placer ()

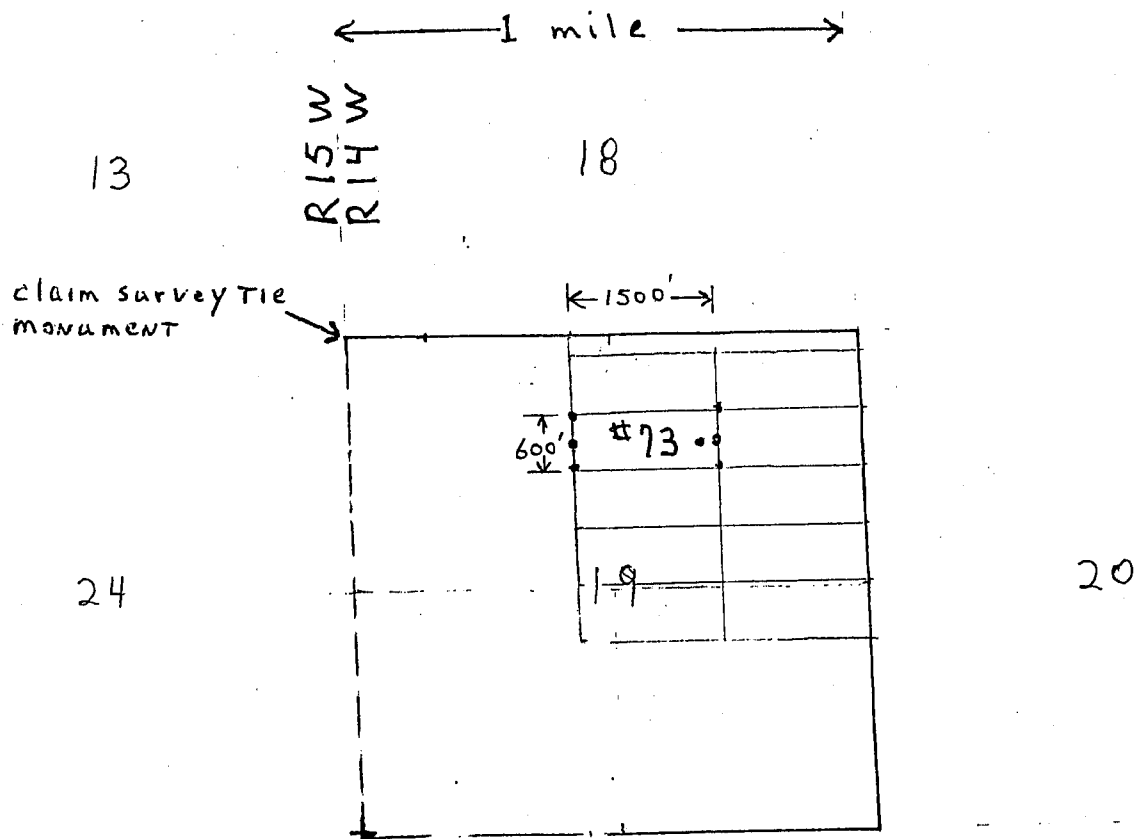

Scale: 1" = 2000 feet

1. The above map depicts the Mohave # 73 mining claim, which is located in Section (s) 19, Township 20 North, Range (s), 14, West, Gila and Salt River Base and Meridian, Mohave County, Arizona.
2. The type of corner and location monuments used are as follows
2" x 2" x 4 ft wooden posts.
3. The bearings and distances in degrees and feet between claim corners are as depicted on the map.

After recording return to:

Pershing Resources
200 S. Virginia St., 8th Floor
Reno, Nevada 89501



FEE# 2018006169

OFFICIAL RECORDS
OF MOHAVE COUNTY
KRISTI BLAIR,
COUNTY RECORDER



02/08/2018 11:24 AM Fee: \$10.00

PAGE: 1 of 2

LOCATION NOTICE for LODE MINING CLAIM

Notice Is Hereby Given that the Mohave # 75
lode mining claim has been located by Nick Barr
whose current mailing address is; 5441 E. Mining
Apache Junction, Arizona 85119 Camp St.

BLM
date
stamp

APR 19 11:19 AM
PHOENIX, ARIZONA

The general course of this claim is EAST-WEST, and is situated in Mohave County, AZ. This claim is 1500 feet in length and 600 feet in width. This claim runs from the location monument, on which this location notice is posted, approximately 1480 feet in a WEST direction to the west end line and 20 feet in an EAST direction to the East end line. This claim is marked by six monuments, one at each corner and one at the center of each end line of the claim.

The location monument on which this notice is posted is situated within Section 19 Township 20 North, Range 14 West, Gila Salt River Base and Meridian, Arizona and this claim encompasses portions of the following quarter sections (s), Township (s), and Range (s) NW 1/4 NE 1/4 Section 19 Township 20 North, Range 14 West, Gila Salt River Base and Meridian, AZ.

The locality of this claim, with reference to some natural object or permanent monument and additional information (if any) concerning its locality are as follows:

The Southwest corner of claim is located 2300 feet EAST and 1950 feet SOUTH of a brass cap permanent survey monument located at the southwest corner of Section 18 Township 20 North, Range 14 West, GSRB&M

DATED and POSTED on the ground this 21 day of

JANUARY, 2018

LOCATOR

Nick Barr
Agent for:

Nick Barr
Pershing Resources
200 S. Virginia St. 8th Floor
Reno, Nevada 89501

AHC450519

MINING CLAIM MAP

Lode (X) Placer ()

← 1 mile →

13

R 15 W
R 14 W

18

claim survey tie monument

24

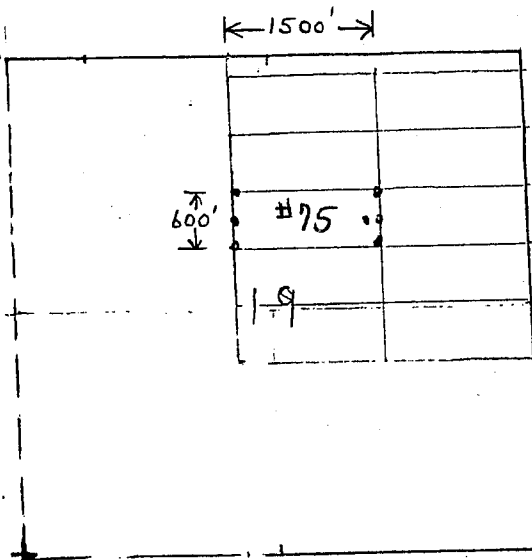

20

Scale: 1" = 2000 feet

↑ N

1. The above map depicts the Mohave # 75 mining claim, which is located in Section (s) 19, Township 20 North, Range (s), 14, West, Gila and Salt River Base and Meridian, Mohave County, Arizona.
2. The type of corner and location monuments used are as follows:
2" x 2" x 4 ft wooden posts.
3. The bearings and distances in degrees and feet between claim corners are as depicted on the map.

2

After recording return to:

Pershing Resources
200 S. Virginia St., 8th Floor
Reno, Nevada 89501

FEE# 2018006171

OFFICIAL RECORDS
OF MOHAVE COUNTY
KRISTI BLAIR,
COUNTY RECORDER



02/08/2018 11:24 AM Fee: \$10.00

PAGE: 1 of 2

LOCATION NOTICE for LODE MINING CLAIM

Notice Is Hereby Given that the Mohave # 77
lode mining claim has been located by Nick Barr
whose current mailing address is; 5441 E. Mining
Apache Junction, Arizona 85119 Camp St.

BLM
date
stamp

2018 APR 19 P
PHOENIX, ARIZ

The general course of this claim is EAST-WEST, and is situated in Mohave County, AZ. This claim is 1500 feet in length and 600 feet in width. This claim runs from the location monument, on which this location notice is posted, approximately 1480 feet in a WEST direction to the west end line and 20 feet in an EAST direction to the East end line. This claim is marked by six monuments, one at each corner and one at the center of each end line of the claim.

The location monument on which this notice is posted is situated within Section 19 Township 20 North, Range 14 West, Gila Salt River Base and Meridian, Arizona and this claim encompasses portions of the following quarter sections (s), Township (s), and Range (s) NW 1/4 NE 1/4 Section 19 Township 20 North, Range 14 West, Gila Salt River Base and Meridian, AZ.

The locality of this claim, with reference to some natural object or permanent monument and additional information (if any) concerning its locality are as follows:

The Southwest corner of claim is located 2300 feet EAST and 2550 feet SOUTH of a brass cap permanent survey monument located at the southwest corner of Section 18 Township 20 North, Range 14 West, GSRB&M

DATED and POSTED on the ground this 21 day of

JANUARY, 2018

LOCATOR

Nick Barr

Nick Barr
Agent for:

Pershing Resources
200 S. Virginia St. 8th Floor
Reno, Nevada 89501

AHC450520

MINING CLAIM MAP

Lode (X) Placer ()

← 1 mile →

R 15 W
R 14 W

18

13

claim survey tie monument

24

20

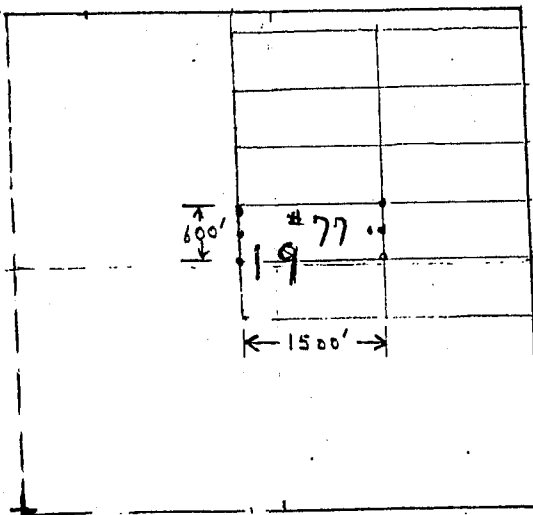

Scale: 1" = 2000 feet

↑ N

1. The above map depicts the Mohave # 77 mining claim, which is located in Section (s) 19, Township 20 North, Range (s), 14, West, Gila and Salt River Base and Meridian, Mohave County, Arizona.
2. The type of corner and location monuments used are as follows:
2" x 2" x 4 ft wooden posts.
3. The bearings and distances in degrees and feet between claim corners are as depicted on the map.

After recording return to:

Pershing Resources
200 S. Virginia St., 8th Floor
Reno, Nevada 89501

FEE# 2018006173

OFFICIAL RECORDS
OF MOHAVE COUNTY
KRISTI BLAIR,
COUNTY RECORDER



02/08/2018 11:24 AM Fee: \$10.00

PAGE: 1 of 2

LOCATION NOTICE for LODE MINING CLAIM

Notice Is Hereby Given that the Mohave # 79
lode mining claim has been located by Nick Barr
whose current mailing address is; 5441 E. Mining
Apache Junction, Arizona 85119 Camp St.

BLM
date
stamp

2018 APR 19 P
PHOENIX, ARIZ

The general course of this claim is EAST-WEST, and is situated in Mohave County, AZ. This claim is 1500 feet in length and 600 feet in width. This claim runs from the location monument, on which this location notice is posted, approximately 1480 feet in a WEST direction to the west end line and 20 feet in an EAST direction to the East end line. This claim is marked by six monuments, one at each corner and one at the center of each end line of the claim.

The location monument on which this notice is posted is situated within Section 19
Township 20 North, Range 14 West, Gila Salt River Base and Meridian, Arizona
and this claim encompasses portions of the following quarter sections (s), Township (s),
and Range (s) NE, NW, SE, SW 1/4 Section 19
Township 20 North, Range 14 West, Gila Salt River Base and Meridian, AZ.

The locality of this claim, with reference to some natural object or permanent monument and additional information (if any) concerning its locality are as follows:

The Southwest corner of claim is located 2300 feet EAST and
3150 feet SOUTH of a brass cap permanent survey monument located
at the southwest corner of Section 18 Township 20 North, Range 14 West, GSRB&M

DATED and POSTED on the ground this 21 day of

JANUARY, 2018

LOCATOR

Nick Barr

Nick Barr
Agent for:

Pershing Resources
200 S. Virginia St. 8th Floor
Reno, Nevada 89501

AHC450521

MINING CLAIM MAP

Lode (X) Placer ()

← 1 mile →

13

R 15 W
R 14 W

18

claim survey tie monument

24

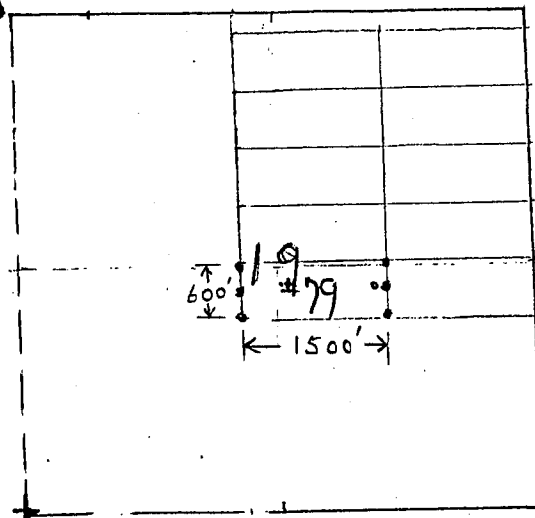

20

Scale: 1" = 2000 feet

↑ N

1. The above map depicts the Mohave # 79 mining claim, which is located in Section(s) 19, Township 20 North, Range (s), 14, West, Gila and Salt River Base and Meridian, Mohave County, Arizona.
2. The type of corner and location monuments used are as follows:
2" x 2" x 4 ft wooden posts.
3. The bearings and distances in degrees and feet between claim corners are as depicted on the map.

2

After recording return to:

Pershing Resources

200 S. Virginia St., 8th Floor

Reno, Nevada 89501

FEE# 2018006175

OFFICIAL RECORDS
OF MOHAVE COUNTY
KRISTI BLAIR,
COUNTY RECORDER



02/08/2018 11:24 AM Fee: \$10.00

PAGE: 1 of 2

LOCATION NOTICE for LODE MINING CLAIM

Notice Is Hereby Given that the Mohave # 81
lode mining claim has been located by Nick Barr
whose current mailing address is; P.O. Box 6688
Apache Junction, Arizona 85178

BLM
date
stamp

2018 APR 19 P 1:10
APACHE JUNCTION, ARIZONA

The general course of this claim is EAST-WEST, and is situated in Mohave County, AZ. This claim is 1500 feet in length and 600 feet in width. This claim runs from the location monument, on which this location notice is posted, approximately 1480 feet in a WEST direction to the west end line and 20 feet in an EAST direction to the East end line. This claim is marked by six monuments, one at each corner and one at the center of each end line of the claim.

The location monument on which this notice is posted is situated within Section 12 Township 20 North, Range 15 West, Gila Salt River Base and Meridian, Arizona and this claim encompasses portions of the following quarter sections (s), Township (s), and Range (s) NW 1/4 Section 12 Township 20 North, Range 15 West, Gila Salt River Base and Meridian, AZ.

The locality of this claim, with reference to some natural object or permanent monument and additional information (if any) concerning its locality are as follows:

The Southwest corner of claim is located 4900 feet WEST and 8280 feet North of a brass cap permanent survey monument located at the southeast corner of Section 13, Township 20 North, Range 15 West, GSRB&M

DATED and POSTED on the ground this 21 day of JANUARY, 2018

LOCATOR

Nick Barr

Nick Barr
Agent for:

Pershing Resources

200 S. Virginia St., 8th Floor

Reno, Nevada 89501

AHC450522

MINING CLAIM MAP

Lode (X) Placer ()

← 1 mile →

6

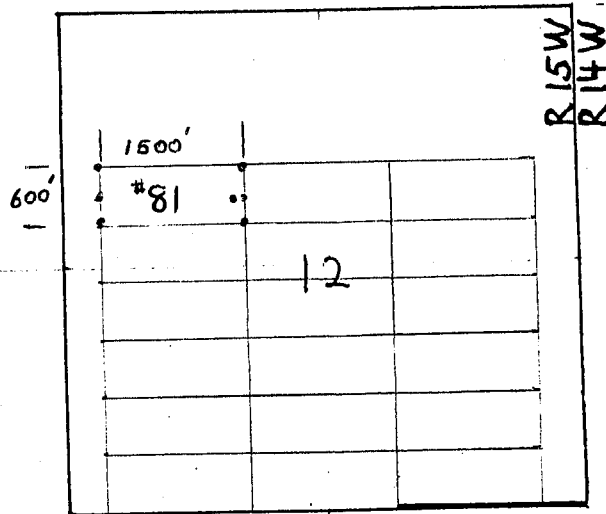

7

13

Scale: 1" = 2000 feet

1
N

18

1. The above map depicts the Mohave # 81 mining claim, which is located in Section (s) 12, Township 20 North, Range (s), 15, West, Gila and Salt River Base and Meridian, Mohave County, Arizona.
2. The type of corner and location monuments used are as follows:
2" x 2" x 4 ft wooden posts.
3. The bearings and distances in degrees and feet between claim corners are as depicted on the map.

After recording return to:

Pershing Resources
200 S. Virginia St., 8th Floor
Reno, Nevada 89501

2

FEE# 2018006176

OFFICIAL RECORDS
OF MOHAVE COUNTY
KRISTI BLAIR,
COUNTY RECORDER



02/08/2018 11:24 AM Fee: \$10.00

PAGE: 1 of 2

LOCATION NOTICE for LODE MINING CLAIM

Notice Is Hereby Given that the Mohave # 82
loade mining claim has been located by Nick Barr
whose current mailing address is; P.O. Box 6688
Apache Junction, Arizona 85178

BLM
date
stamp

2018 APR 19 P
PHOENIX, ARIZ

The general course of this claim is EAST-WEST, and is situated in Mohave County, AZ. This claim is 1500 feet in length and 600 feet in width. This claim runs from the location monument, on which this location notice is posted, approximately 20 feet in a WEST direction to the west end line and 1480 feet in an EAST direction to the East end line. This claim is marked by six monuments, one at each corner and one at the center of each end line of the claim.

The location monument on which this notice is posted is situated within Section 12 Township 20 North, Range 15 West, Gila Salt River Base and Meridian, Arizona and this claim encompasses portions of the following quarter sections (s), Township (s), and Range (s) NW 1/4 NE 1/4 Section 12 Township 20 North, Range 15 West, Gila Salt River Base and Meridian, AZ.

The locality of this claim, with reference to some natural object or permanent monument and additional information (if any) concerning its locality are as follows:

The Southwest corner of claim is located 3400 feet WEST and 8280 feet North of a brass cap permanent survey monument located at the southeast corner of Section 13, Township 20 North, Range 15 West, GSRB&M

DATED and POSTED on the ground this 21 day of JANUARY, 2018

LOCATOR

Nick Barr
Nick Barr

Agent for:

Pershing Resources

200 S. Virginia St., 8th Floor

Reno, Nevada 89501

AHC450523

MINING CLAIM MAP

Lode (X) Placer ()

← 1 mile →

6

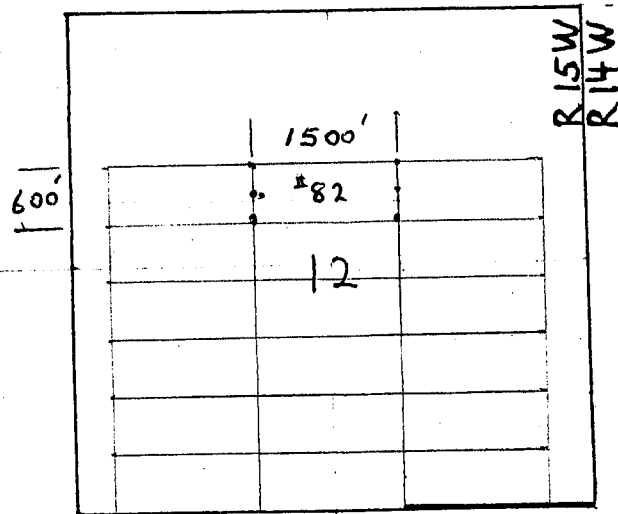

7

13

Scale: 1" = 2000 feet

1 N

18

1. The above map depicts the Mohave # 82 mining claim, which is located in Section (s) 12, Township 20 North, Range (s), 15, West, Gila and Salt River Base and Meridian, Mohave County, Arizona.
2. The type of corner and location monuments used are as follows:
2" x 2" x 4 ft wooden posts.
3. The bearings and distances in degrees and feet between claim corners are as depicted on the map.

After recording return to:

Pershing Resources
200 S. Virginia St., 8th Floor
Reno, Nevada 89501

2
FEE# 2018006177

OFFICIAL RECORDS
OF MOHAVE COUNTY
KRISTI BLAIR,
COUNTY RECORDER



02/08/2018 11:24 AM Fee: \$10.00

PAGE: 1 of 2

LOCATION NOTICE for LODE MINING CLAIM

Notice Is Hereby Given that the Mohave # 83
lode mining claim has been located by Nick Barr
whose current mailing address is; P.O. Box 6688
Apache Junction, Arizona 85178

BLM
date
stamp

CHOCOMA, ARIZONA

2018 APR 19 P 1:18

The general course of this claim is EAST-WEST, and is situated in Mohave County, AZ. This claim is 1500 feet in length and 600 feet in width. This claim runs from the location monument, on which this location notice is posted, approximately 1480 feet in a WEST direction to the west end line and 20 feet in an EAST direction to the East end line. This claim is marked by six monuments, one at each corner and one at the center of each end line of the claim.

The location monument on which this notice is posted is situated within Section 12 Township 20 North, Range 15 West, Gila Salt River Base and Meridian, Arizona and this claim encompasses portions of the following quarter sections (s), Township (s), and Range (s) NE 1/4 Section 12 Township 20 North, Range 15 West, Gila Salt River Base and Meridian, AZ.

The locality of this claim, with reference to some natural object or permanent monument and additional information (if any) concerning its locality are as follows:

The Southwest corner of claim is located 1900 feet WEST and 8280 feet North of a brass cap permanent survey monument located at the southeast corner of Section 13, Township 20 North, Range 15 West, GSRB&M

DATED and POSTED on the ground this 21 day of JANUARY, 2018

LOCATOR

Nick Barr

Agent for:

Pershing Resources

200 S. Virginia St., 8th Floor

Reno, Nevada 89501

AHC450524

MINING CLAIM MAP

Lode (X) Placer ()

← 1 mile →

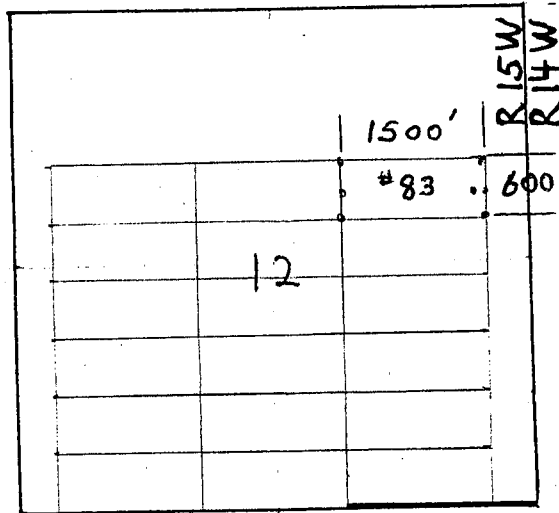

13
Scale: 1" = 2000 feet

18
↑ N

1. The above map depicts the Mohave # 83 mining claim, which is located in Section (s) 12, Township 20 North, Range (s), 15, West, Gila and Salt River Base and Meridian, Mohave County, Arizona.
2. The type of corner and location monuments used are as follows:
2" x 2" x 4 ft wooden posts.
3. The bearings and distances in degrees and feet between claim corners are as depicted on the map.

2
After recording return to:

Pershing Resources

200 S. Virginia St., 8th Floor

Reno, Nevada 89501

FEE# 2018006178

OFFICIAL RECORDS
OF MOHAVE COUNTY
KRISTI BLAIR,
COUNTY RECORDER



02/08/2018 11:24 AM Fee: \$10.00

PAGE: 1 of 2

LOCATION NOTICE for LODE MINING CLAIM

Notice Is Hereby Given that the Mohave # 84
lode mining claim has been located by Nick Barr
whose current mailing address is; P.O. Box 6688
Apache Junction, Arizona 85178

BLM
date
stamp

2018 APR 19 P 1
APACHE JUNCTION, ARIZONA

The general course of this claim is EAST-WEST, and is situated in Mohave County, AZ. This claim is 1500 feet in length and 600 feet in width. This claim runs from the location monument, on which this location notice is posted, approximately 1480 feet in a WEST direction to the west end line and 20 feet in an EAST direction to the East end line. This claim is marked by six monuments, one at each corner and one at the center of each end line of the claim.

The location monument on which this notice is posted is situated within Section 12 Township 20 North, Range 15 West, Gila Salt River Base and Meridian, Arizona and this claim encompasses portions of the following quarter sections (s), Township (s), and Range (s) NW 15W 14 Section 12 Township 20 North, Range 15 West, Gila Salt River Base and Meridian, AZ.

The locality of this claim, with reference to some natural object or permanent monument and additional information (if any) concerning its locality are as follows:

The Southwest corner of claim is located 4900 feet WEST and 7680 feet North of a brass cap permanent survey monument located at the southeast corner of Section 13, Township 20 North, Range 15 West, GSRB&M

DATED and POSTED on the ground this 21 day of JANUARY, 2018

LOCATOR

Nick Barr

Agent for:

Pershing Resources

200 S. Virginia St., 8th Floor

Reno, Nevada 89501

AHC450525

Lode (X) Placer ()

Lode (X) Placer ()

← 1 mile →

6

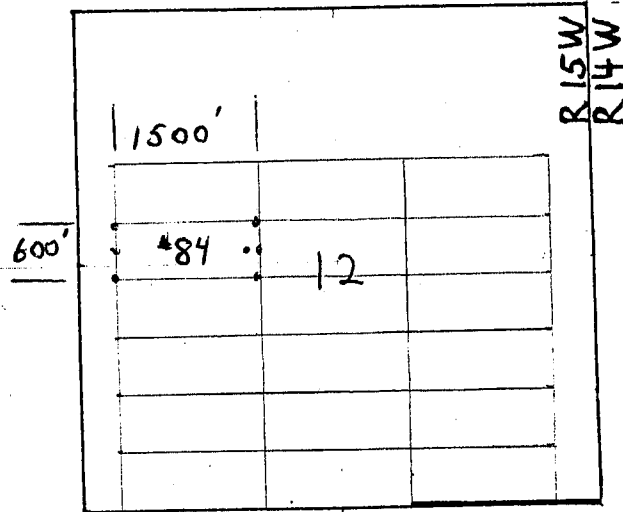

600'

484

42

$$\begin{array}{r} R\ 15W \\ \hline R\ 14W \end{array}$$

R14W

7

13

Scale: 1" = 2000 feet

12

18

1. The above map depicts the Mohave # 84 mining claim, which is located in Section (s) 12, Township 20 North, Range (s), 15, West, Gila and Salt River Base and Meridian, Mohave County, Arizona.
2. The type of corner and location monuments used are as follows:
2" x 2" x 4 ft wooden posts.
3. The bearings and distances in degrees and feet between claim corners are as depicted on the map.

2. The type of corner and location monuments used are as follows:
2" x 2" x 4 ft wooden posts.

3. The bearings and distances in degrees and feet between claim corners are as depicted on the map.

After recording return to:

Pershing Resources
200 S. Virginia St., 8th Floor
Reno, Nevada 89501

2

FEE# 2018006179

OFFICIAL RECORDS
OF MOHAVE COUNTY
KRISTI BLAIR,
COUNTY RECORDER



02/08/2018 11:24 AM Fee: \$10.00

PAGE: 1 of 2

LOCATION NOTICE for LODE MINING CLAIM

Notice Is Hereby Given that the Mohave # 85
loade mining claim has been located by Nick Barr
whose current mailing address is; P.O. Box 6688
Apache Junction, Arizona 85178

BLM
date
stamp

2018 APR 19 P
PHOENIX, ARIZ

The general course of this claim is EAST-WEST, and is situated in Mohave County, AZ. This claim is 1500 feet in length and 600 feet in width. This claim runs from the location monument, on which this location notice is posted, approximately 20 feet in a WEST direction to the west end line and 1480 feet in an EAST direction to the East end line. This claim is marked by six monuments, one at each corner and one at the center of each end line of the claim.

The location monument on which this notice is posted is situated within Section 12 Township 20 North, Range 15 West, Gila Salt River Base and Meridian, Arizona and this claim encompasses portions of the following quarter sections (s), Township (s), and Range (s) NW 1/4, NE 1/4, SE 1/4 Section 12 Township 20 North, Range 15 West, Gila Salt River Base and Meridian, AZ.

The locality of this claim, with reference to some natural object or permanent monument and additional information (if any) concerning its locality are as follows:

The Southwest corner of claim is located 3400 feet WEST and 7680 feet North of a brass cap permanent survey monument located at the southeast corner of Section 13, Township 20 North, Range 15 West, GSRB&M

DATED and POSTED on the ground this 21 day of JANUARY, 2018

LOCATOR

Nick Barr

Nick Barr

Agent for:

Pershing Resources

200 S. Virginia St., 8th Floor

Reno, Nevada 89501

AHC450526

MINING CLAIM MAP

Lode (X) Placer ()

← 1 mile →

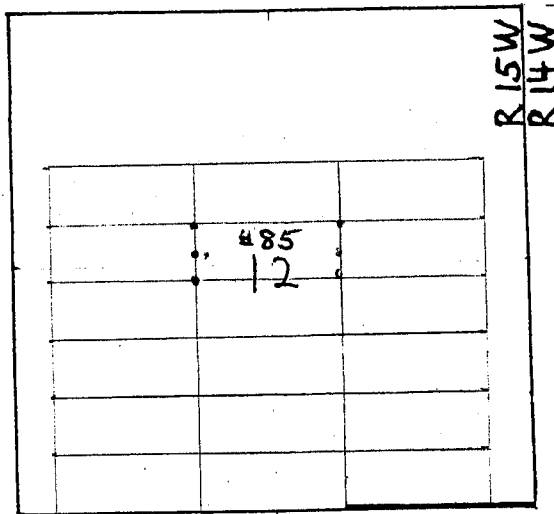

13
Scale: 1" = 2000 feet

1. The above map depicts the Mohave # 85 mining claim, which is located in Section (s) 12, Township 20 North, Range (s), 15, West, Gila and Salt River Base and Meridian, Mohave County, Arizona.
2. The type of corner and location monuments used are as follows:
2" x 2" x 4 ft. wooden posts.
3. The bearings and distances in degrees and feet between claim corners are as depicted on the map.

After recording return to:

Pershing Resources

200 S. Virginia St., 8th Floor

Reno, Nevada 89501

2
FEE# 2018006180

OFFICIAL RECORDS
OF MOHAVE COUNTY
KRISTI BLAIR,
COUNTY RECORDER



02/08/2018 11:24 AM Fee: \$10.00

PAGE: 1 of 2

LOCATION NOTICE for LODE MINING CLAIM

Notice Is Hereby Given that the Mohave # 86
lode mining claim has been located by Nick Barr
whose current mailing address is; P.O. Box 6688
Apache Junction, Arizona 85178

BLM
date
stamp

2018 APR 19 P
PHOENIX, ARIZONA

The general course of this claim is EAST-WEST, and is situated in Mohave County, AZ. This claim is 1500 feet in length and 600 feet in width. This claim runs from the location monument, on which this location notice is posted, approximately 1480 feet in a WEST direction to the west end line and 20 feet in an EAST direction to the East end line. This claim is marked by six monuments, one at each corner and one at the center of each end line of the claim.

The location monument on which this notice is posted is situated within Section 12 Township 20 North, Range 15 West, Gila Salt River Base and Meridian, Arizona and this claim encompasses portions of the following quarter sections (s), Township (s), and Range (s) NE 1 SE 1/4 Section 12 Township 20 North, Range 15 West, Gila Salt River Base and Meridian, AZ.

The locality of this claim, with reference to some natural object or permanent monument and additional information (if any) concerning its locality are as follows:

The Southwest corner of claim is located 1900 feet WEST and 7680 feet North of a brass cap permanent survey monument located at the southeast corner of Section 13, Township 20 North, Range 15 West, GSRB&M

DATED and POSTED on the ground this 21 day of JANUARY, 2018

LOCATOR

Nick Barr
Nick Barr

Agent for:

Pershing Resources

200 S. Virginia St., 8th Floor

Reno, Nevada 89501

AHC450527

MINING CLAIM MAP

Lode (X) Placer ()

← 1 mile →

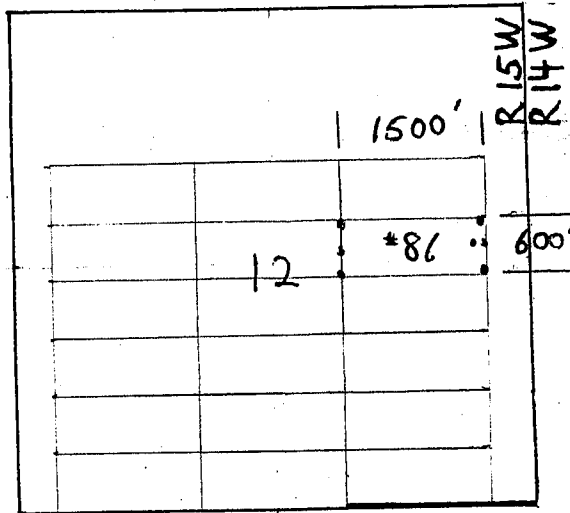

13
Scale: 1" = 2000 feet

18
1 N

1. The above map depicts the Mohave # 86 mining claim, which is located in Section (s) 12, Township 20 North, Range (s), 15, West, Gila and Salt River Base and Meridian, Mohave County, Arizona.
2. The type of corner and location monuments used are as follows:
2" x 2" x 4 ft wooden posts.
3. The bearings and distances in degrees and feet between claim corners are as depicted on the map.

2
After recording return to:

Pershing Resources

200 S. Virginia St., 8th Floor

Reno, Nevada 89501

FEE# 2018006181

OFFICIAL RECORDS
OF MOHAVE COUNTY
KRISTI BLAIR,
COUNTY RECORDER



02/08/2018 11:24 AM Fee: \$10.00

PAGE: 1 of 2

LOCATION NOTICE for LODE MINING CLAIM

Notice Is Hereby Given that the Mohave # 87
loade mining claim has been located by Nick Barr
whose current mailing address is; P.O. Box 6688
Apache Junction, Arizona 85178

BLM
date
stamp

2018 APR 19 P 1:11
MOHAVE COUNTY, ARIZONA

The general course of this claim is EAST-WEST, and is situated in Mohave County, AZ. This claim is 1500 feet in length and 600 feet in width. This claim runs from the location monument, on which this location notice is posted, approximately 1480 feet in a WEST direction to the west end line and 20 feet in an EAST direction to the East end line. This claim is marked by six monuments, one at each corner and one at the center of each end line of the claim.

The location monument on which this notice is posted is situated within Section 12 Township 20 North, Range 15 West, Gila Salt River Base and Meridian, Arizona and this claim encompasses portions of the following quarter sections (s), Township (s), and Range (s) SW 1/4 Section 12 Township 20 North, Range 15 West, Gila Salt River Base and Meridian, AZ.

The locality of this claim, with reference to some natural object or permanent monument and additional information (if any) concerning its locality are as follows:

The Southwest corner of claim is located 4900 feet WEST and 7080 feet North of a brass cap permanent survey monument located at the southeast corner of Section 13, Township 20 North, Range 15 West, GSRB&M

DATED and POSTED on the ground this 21 day of JANUARY, 2018

LOCATOR

Nick Barr

Nick Barr

Agent for:

Pershing Resources

200 S. Virginia St., 8th Floor

Reno, Nevada 89501

AHC450528

MINING CLAIM MAP

Lode (X) Placer ()

← 1 mile →

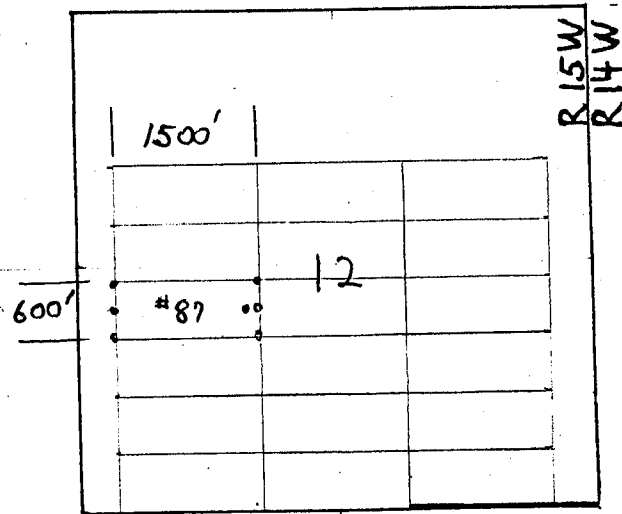

13
Scale: 1" = 2000 feet

18
1 N

1. The above map depicts the Mohave # 87 mining claim, which is located in Section (s) 12, Township 20 North, Range (s), 15, West, Gila and Salt River Base and Meridian, Mohave County, Arizona.
2. The type of corner and location monuments used are as follows:
2" x 2" x 4 ft wooden posts.
3. The bearings and distances in degrees and feet between claim corners are as depicted on the map.

After recording return to:

Pershing Resources
200 S. Virginia St., 8th Floor
Reno, Nevada 89501

2
FEE# 2018006182

OFFICIAL RECORDS
OF MOHAVE COUNTY
KRISTI BLAIR,
COUNTY RECORDER



02/08/2018 11:24 AM Fee: \$10.00

PAGE: 1 of 2

LOCATION NOTICE for LODE MINING CLAIM

Notice Is Hereby Given that the Mohave # 89
lode mining claim has been located by Nick Barr
whose current mailing address is; P.O. Box 6688
Apache Junction, Arizona 85178

BLM
date
stamp

RECEIVED
APR 19 P 1:
MOHAVE COUNTY ARIZONA

The general course of this claim is EAST-WEST, and is situated in Mohave County, AZ. This claim is 1500 feet in length and 600 feet in width. This claim runs from the location monument, on which this location notice is posted, approximately 1480 feet in a WEST direction to the west end line and 20 feet in an EAST direction to the East end line. This claim is marked by six monuments, one at each corner and one at the center of each end line of the claim.

The location monument on which this notice is posted is situated within Section 12 Township 20 North, Range 15 West, Gila Salt River Base and Meridian, Arizona and this claim encompasses portions of the following quarter section (s), Township (s), and Range (s) SE 1/4 Section 12 Township 20 North, Range 15 West, Gila Salt River Base and Meridian, AZ.

The locality of this claim, with reference to some natural object or permanent monument and additional information (if any) concerning its locality are as follows:

The Southwest corner of claim is located 1900 feet WEST and 7080 feet North of a brass cap permanent survey monument located at the southeast corner of Section 13, Township 20 North, Range 15 West, GSRB&M

DATED and POSTED on the ground this 21 day of JANUARY, 2018

LOCATOR

Nick Barr
Nick Barr
Agent for:

Pershing Resources
200 S. Virginia St., 8th Floor
Reno, Nevada 89501

AHC450529

MINING CLAIM MAP

Lode (X) Placer ()

← 1 mile →

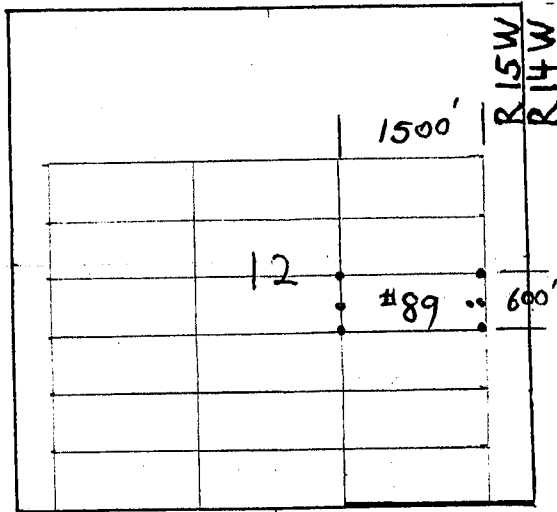

13
Scale: 1" = 2000 feet

18
↑ N

1. The above map depicts the Mohave # 89 mining claim, which is located in Section (s) 12, Township 20 North, Range (s), 15, West, Gila and Salt River Base and Meridian, Mohave County, Arizona.
2. The type of corner and location monuments used are as follows:
2" x 2" x 4 ft wooden posts.
3. The bearings and distances in degrees and feet between claim corners are as depicted on the map.

After recording return to:

Pershing Resources
200 S. Virginia St., 8th Floor
Reno, Nevada 89501

FEE# 2018006183

OFFICIAL RECORDS
OF MOHAVE COUNTY
KRISTI BLAIR,
COUNTY RECORDER



02/08/2018 11:24 AM Fee: \$10.00

PAGE: 1 of 2

LOCATION NOTICE for LODE MINING CLAIM

Notice Is Hereby Given that the Mohave # 88
lode mining claim has been located by Nick Barr
whose current mailing address is; P.O. Box 6688
Apache Junction, Arizona 85178

BLM
date
stamp

2018 APR 19 P 1:18
APACHE JUNCTION, ARIZONA

The general course of this claim is EAST-WEST, and is situated in Mohave County, AZ. This claim is 1500 feet in length and 600 feet in width. This claim runs from the location monument, on which this location notice is posted, approximately 20 feet in a WEST direction to the west end line and 1480 feet in an EAST direction to the East end line. This claim is marked by six monuments, one at each corner and one at the center of each end line of the claim.

The location monument on which this notice is posted is situated within Section 12 Township 20 North, Range 15 West, Gila Salt River Base and Meridian, Arizona and this claim encompasses portions of the following quarter sections (s), Township (s), and Range (s) SW 1/4 SE 1/4 Section 12 Township 20 North, Range 15 West, Gila Salt River Base and Meridian, AZ.

The locality of this claim, with reference to some natural object or permanent monument and additional information (if any) concerning its locality are as follows:

The Southwest corner of claim is located 3400 feet WEST and 7080 feet North of a brass cap permanent survey monument located at the southeast corner of Section 13, Township 20 North, Range 15 West, GSRB&M

DATED and POSTED on the ground this 21 day of JANUARY, 2018

LOCATOR

Nick Barr
Agent for:

Pershing Resources
200 S. Virginia St., 8th Floor
Reno, Nevada 89501

AHC450530

MINING CLAIM MAP

Lode (X) Placer ()

← 1 mile →

1

6

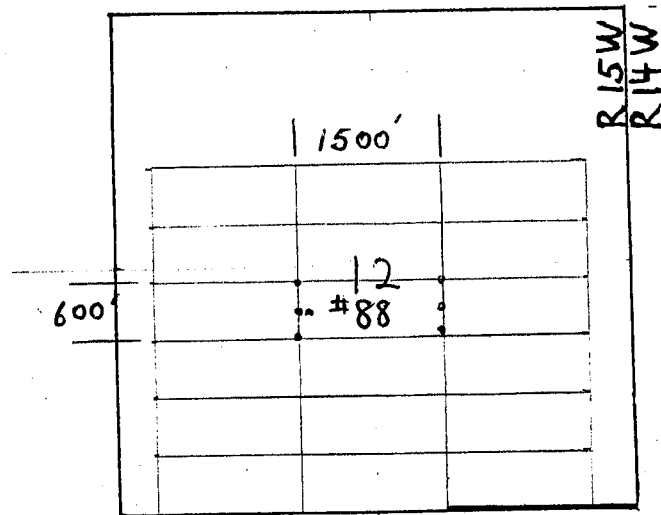

7

13

Scale: 1" = 2000 feet

1 N

18

1. The above map depicts the Mohave # 88 mining claim, which is located in Section (s) 12, Township 20 North, Range (s), 15, West, Gila and Salt River Base and Meridian, Mohave County, Arizona.
2. The type of corner and location monuments used are as follows:
2" x 2" x 4 ft wooden posts.
3. The bearings and distances in degrees and feet between claim corners are as depicted on the map.

2
After recording return to:

Pershing Resources

200 S. Virginia St., 8th Floor

Reno, Nevada 89501

FEE# 2018006184

OFFICIAL RECORDS
OF MOHAVE COUNTY
KRISTI BLAIR,
COUNTY RECORDER



02/08/2018 11:24 AM Fee: \$10.00

PAGE: 1 of 2

LOCATION NOTICE for LODE MINING CLAIM

Notice Is Hereby Given that the Mohave # 90
lode mining claim has been located by Nick Barr
whose current mailing address is; P.O. Box 6688
Apache Junction, Arizona 85178

BLM
date
stamp

2018 APR 19 P 1:18
CRIMENX, ARIZONA

The general course of this claim is EAST-WEST, and is situated in Mohave County, AZ. This claim is 1500 feet in length and 600 feet in width. This claim runs from the location monument, on which this location notice is posted, approximately 1480 feet in a WEST direction to the west end line and 20 feet in an EAST direction to the East end line. This claim is marked by six monuments, one at each corner and one at the center of each end line of the claim.

The location monument on which this notice is posted is situated within Section 12 Township 20 North, Range 15 West, Gila Salt River Base and Meridian, Arizona and this claim encompasses portions of the following quarter sections (s), Township (s), and Range (s) SW 1/4 Section 12 Township 20 North, Range 15 West, Gila Salt River Base and Meridian, AZ.

The locality of this claim, with reference to some natural object or permanent monument and additional information (if any) concerning its locality are as follows:

The Southwest corner of claim is located 4900 feet WEST and 6480 feet North of a brass cap permanent survey monument located at the southeast corner of Section 13, Township 20 North, Range 15 West, GSRB&M

DATED and POSTED on the ground this 21 day of JANUARY, 2018

LOCATOR

Nick Barr
Nick Barr

Agent for:

Pershing Resources

200 S. Virginia St., 8th Floor

Reno, Nevada 89501

AHC450531

MINING CLAIM MAP

Lode (X) Placer ()

← 1 mile →

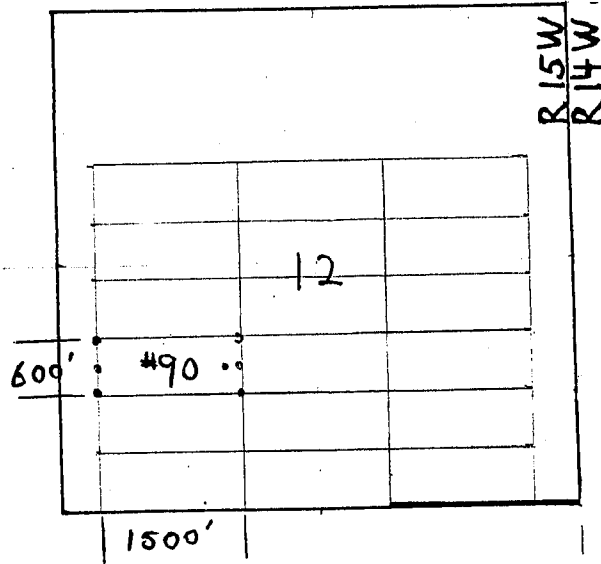

13
Scale: 1" = 2000 feet

18
↑ N

1. The above map depicts the Mohave # 90 mining claim, which is located in Section (s) 12, Township 20 North, Range (s), 15, West, Gila and Salt River Base and Meridian, Mohave County, Arizona.
2. The type of corner and location monuments used are as follows:
2" x 2" x 4 ft wooden posts.
3. The bearings and distances in degrees and feet between claim corners are as depicted on the map.

After recording return to:

Pershing Resources
200 S. Virginia St., 8th Floor
Reno, Nevada 89501

2
FEE# 2018006185

OFFICIAL RECORDS
OF MOHAVE COUNTY
KRISTI BLAIR,
COUNTY RECORDER



02/08/2018 11:24 AM Fee: \$10.00

PAGE: 1 of 2

LOCATION NOTICE for LODE MINING CLAIM

Notice Is Hereby Given that the Mohave # 91
lode mining claim has been located by Nick Barr
whose current mailing address is; P.O. Box 6688
Apache Junction, Arizona 85178

BLM
date
stamp

2018 APR 19 P 1:19
PERSHING, ARIZONA

The general course of this claim is EAST-WEST, and is situated in Mohave County, AZ. This claim is 1500 feet in length and 600 feet in width. This claim runs from the location monument, on which this location notice is posted, approximately 20 feet in a WEST direction to the west end line and 1480 feet in an EAST direction to the East end line. This claim is marked by six monuments, one at each corner and one at the center of each end line of the claim.

The location monument on which this notice is posted is situated within Section 12 Township 20 North, Range 15 West, Gila Salt River Base and Meridian, Arizona and this claim encompasses portions of the following quarter sections (s), Township (s), and Range (s) SW 1/4 SE 1/4 Section 12 Township 20 North, Range 15 West, Gila Salt River Base and Meridian, AZ.

The locality of this claim, with reference to some natural object or permanent monument and additional information (if any) concerning its locality are as follows:

The Southwest corner of claim is located 3400 feet WEST and 6480 feet North of a brass cap permanent survey monument located at the southeast corner of Section 13, Township 20 North, Range 15 West, GSRB&M

DATED and POSTED on the ground this 21 day of JANUARY, 2018

LOCATOR

Nick Barr

Nick Barr
Agent for:

Pershing Resources
200 S. Virginia St., 8th Floor
Reno, Nevada 89501

AHC450532

MINING CLAIM MAP

Lode (X) Placer ()

← 1 mile →

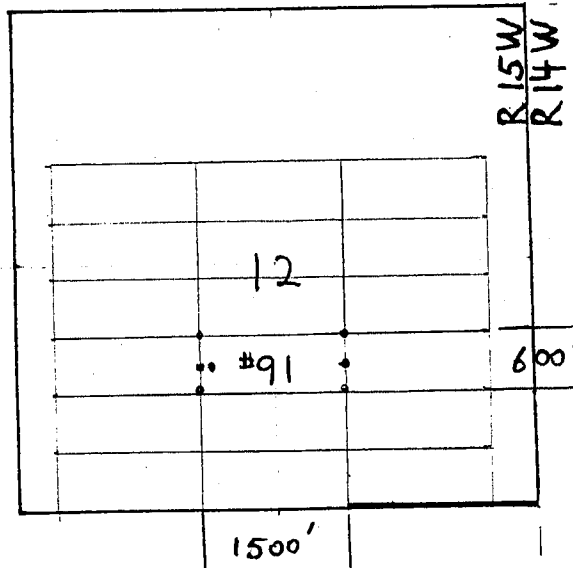

Scale: 1" = 2000 feet

1. The above map depicts the Mohave # 91 mining claim, which is located in Section (s) 12, Township 20 North, Range (s), 15, West, Gila and Salt River Base and Meridian, Mohave County, Arizona.
2. The type of corner and location monuments used are as follows:
2" x 2" x 4 ft wooden posts.
3. The bearings and distances in degrees and feet between claim corners are as depicted on the map.

After recording return to:

Pershing Resources
200 S. Virginia St., 8th Floor
Reno, Nevada 89501

2

FEE# 2018006186

OFFICIAL RECORDS
OF MOHAVE COUNTY
KRISTI BLAIR,
COUNTY RECORDER



02/08/2018 11:24 AM Fee: \$10.00

PAGE: 1 of 2

LOCATION NOTICE for LODE MINING CLAIM

Notice Is Hereby Given that the Mohave # 92
lode mining claim has been located by Nick Barr
whose current mailing address is; P.O. Box 6688
Apache Junction, Arizona 85178

BLM
date
stamp

2018 APR 19 P 1:10
MOHAVE COUNTY, ARIZONA

The general course of this claim is EAST-WEST, and is situated in Mohave County, AZ. This claim is 1500 feet in length and 600 feet in width. This claim runs from the location monument, on which this location notice is posted, approximately 1480 feet in a WEST direction to the west end line and 20 feet in an EAST direction to the East end line. This claim is marked by six monuments, one at each corner and one at the center of each end line of the claim.

The location monument on which this notice is posted is situated within Section 12 Township 20 North, Range 15 West, Gila Salt River Base and Meridian, Arizona and this claim encompasses portions of the following quarter sections (s), Township (s), and Range (s) SE 1/4 Section 12 Township 20 North, Range 15 West, Gila Salt River Base and Meridian, AZ.

The locality of this claim, with reference to some natural object or permanent monument and additional information (if any) concerning its locality are as follows:

The Southwest corner of claim is located 1900 feet WEST and 6480 feet North of a brass cap permanent survey monument located at the southeast corner of Section 13, Township 20 North, Range 15 West, GSRB&M

DATED and POSTED on the ground this 21 day of JANUARY, 2018

LOCATOR

Nick Barr

Nick Barr

Agent for:

Pershing Resources

200 S. Virginia St., 8th Floor

Reno, Nevada 89501

AHC450533

MINING CLAIM MAP

Lode (X) Placer ()

← 1 mile →

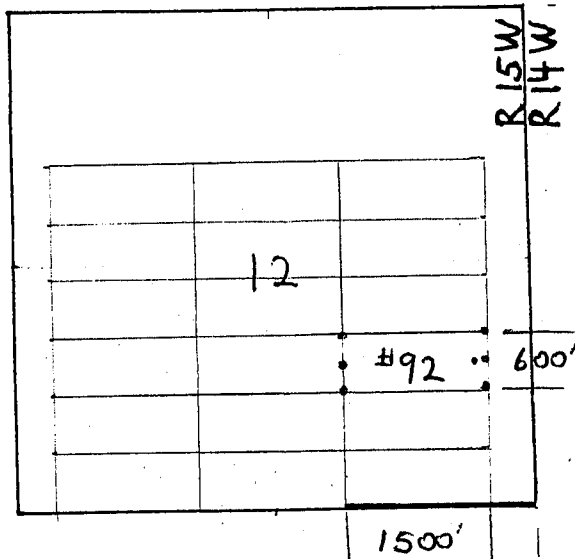

Scale: 1" = 2000 feet

1. The above map depicts the Mohave # 92 mining claim, which is located in Section (s) 12, Township 20 North, Range (s), 15, West, Gila and Salt River Base and Meridian, Mohave County, Arizona.
2. The type of corner and location monuments used are as follows:
2" x 2" x 4 ft wooden posts.
3. The bearings and distances in degrees and feet between claim corners are as depicted on the map.

2
After recording return to:

Pershing Resources

200 S. Virginia St., 8th Floor

Reno, Nevada 89501

FEE# 2018006187

OFFICIAL RECORDS
OF MOHAVE COUNTY
KRISTI BLAIR,
COUNTY RECORDER



02/08/2018 11:24 AM Fee: \$10.00

PAGE: 1 of 2

LOCATION NOTICE for LODE MINING CLAIM

Notice Is Hereby Given that the Mohave # 93
loade mining claim has been located by Nick Barr
whose current mailing address is; P.O. Box 6688
Apache Junction, Arizona 85178

BLM
date
stamp

2018 APR 19 P 1:1
PHOENIX, ARIZONA

The general course of this claim is EAST-WEST, and is situated in Mohave County, AZ. This claim is 1500 feet in length and 600 feet in width. This claim runs from the location monument, on which this location notice is posted, approximately 1480 feet in a WEST direction to the west end line and 20 feet in an EAST direction to the East end line. This claim is marked by six monuments, one at each corner and one at the center of each end line of the claim.

The location monument on which this notice is posted is situated within Section 12 Township 20 North, Range 15 West, Gila Salt River Base and Meridian, Arizona and this claim encompasses portions of the following quarter sections (s), Township (s), and Range (s) SW 1/4 Section 12 Township 20 North, Range 15 West, Gila Salt River Base and Meridian, AZ.

The locality of this claim, with reference to some natural object or permanent monument and additional information (if any) concerning its locality are as follows:

The Southwest corner of claim is located 4900 feet WEST and 5880 feet North of a brass cap permanent survey monument located at the southeast corner of Section 13, Township 20 North, Range 15 West, GSRB&M

DATED and POSTED on the ground this 21 day of JANUARY, 2018

LOCATOR

Nick Barr

Nick Barr

Agent for:

Pershing Resources

200 S. Virginia St., 8th Floor

Reno, Nevada 89501

AHC450534

MINING CLAIM MAP

Lode (X) Placer ()

← 1 mile →

1

6

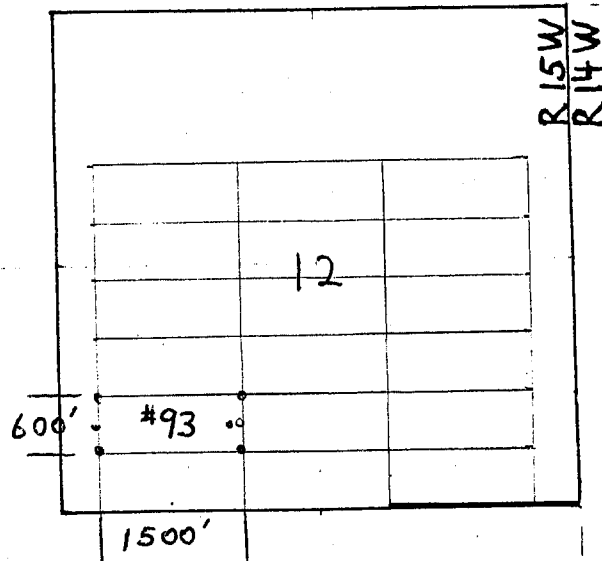

7

13

Scale: 1" = 2000 feet

1 N

18

1. The above map depicts the Mohave # 93 mining claim, which is located in Section (s) 12, Township 20 North, Range (s), 15, West, Gila and Salt River Base and Meridian, Mohave County, Arizona.
2. The type of corner and location monuments used are as follows:
2" x 2" x 4 ft wooden posts.
3. The bearings and distances in degrees and feet between claim corners are as depicted on the map.

2

After recording return to:

Pershing Resources
200 S. Virginia St., 8th Floor
Reno, Nevada 89501

FEE# 2018006188

OFFICIAL RECORDS
OF MOHAVE COUNTY
KRISTI BLAIR,
COUNTY RECORDER



02/08/2018 11:24 AM Fee: \$10.00

PAGE: 1 of 2

LOCATION NOTICE for LODE MINING CLAIM

Notice Is Hereby Given that the Mohave # 94
lode mining claim has been located by Nick Barr
whose current mailing address is; P.O. Box 6688
Apache Junction, Arizona 85178

BLM
date
stamp

2018 APR 19 P 1:19
PHOENIX, ARIZONA

The general course of this claim is EAST-WEST, and is situated in Mohave County, AZ. This claim is 1500 feet in length and 600 feet in width. This claim runs from the location monument, on which this location notice is posted, approximately 20 feet in a WEST direction to the west end line and 1480 feet in an EAST direction to the East end line. This claim is marked by six monuments, one at each corner and one at the center of each end line of the claim.

The location monument on which this notice is posted is situated within Section 12 Township 20 North, Range 15 West, Gila Salt River Base and Meridian, Arizona and this claim encompasses portions of the following quarter sections (s), Township (s), and Range (s) SW 1/4 SE 1/4 Section 12 Township 20 North, Range 15 West, Gila Salt River Base and Meridian, AZ.

The locality of this claim, with reference to some natural object or permanent monument and additional information (if any) concerning its locality are as follows:

The Southwest corner of claim is located 3400 feet WEST and 5880 feet North of a brass cap permanent survey monument located at the southeast corner of Section 13, Township 20 North, Range 15 West, GSRB&M

DATED and POSTED on the ground this 21 day of JANUARY, 2018

LOCATOR

Nick Barr

Nick Barr
Agent for:

Pershing Resources
200 S. Virginia St., 8th Floor
Reno, Nevada 89501

AHC450535

MINING CLAIM MAP

Lode (X) Placer ()

← 1 mile →

1

6

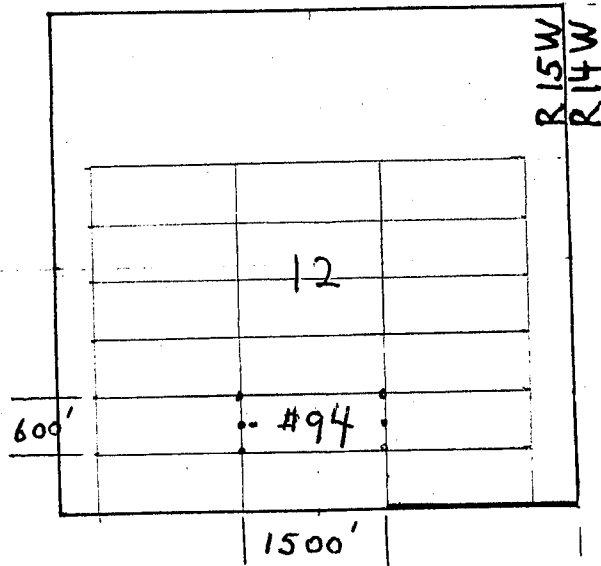

7

13

Scale: 1" = 2000 feet

↑ N

18

1. The above map depicts the Mohave # 94 mining claim, which is located in Section (s) 12, Township 20 North, Range (s), 15, West, Gila and Salt River Base and Meridian, Mohave County, Arizona.
2. The type of corner and location monuments used are as follows:
2" x 2" x 4 ft wooden posts.
3. The bearings and distances in degrees and feet between claim corners are as depicted on the map.

2
After recording return to:

Pershing Resources

200 S. Virginia St., 8th Floor

Reno, Nevada 89501

FEE# 2018006189

OFFICIAL RECORDS
OF MOHAVE COUNTY
KRISTI BLAIR,
COUNTY RECORDER



02/08/2018 11:24 AM Fee: \$10.00

PAGE: 1 of 2

LOCATION NOTICE for LODE MINING CLAIM

Notice Is Hereby Given that the Mohave # 95
lode mining claim has been located by Nick Barr
whose current mailing address is; P.O. Box 6688
Apache Junction, Arizona 85178

BLM
date
stamp

2018 APR 19 P 1:11
MOHAVE COUNTY, ARIZONA

The general course of this claim is EAST-WEST, and is situated in Mohave County, AZ. This claim is 1500 feet in length and 600 feet in width. This claim runs from the location monument, on which this location notice is posted, approximately 1480 feet in a WEST direction to the west end line and 20 feet in an EAST direction to the East end line. This claim is marked by six monuments, one at each corner and one at the center of each end line of the claim.

The location monument on which this notice is posted is situated within Section 12 Township 20 North, Range 15 West, Gila Salt River Base and Meridian, Arizona and this claim encompasses portions of the following quarter sections (s), Township (s), and Range (s) SW 1/4 Section 12 Township 20 North, Range 15 West, Gila Salt River Base and Meridian, AZ.

The locality of this claim, with reference to some natural object or permanent monument and additional information (if any) concerning its locality are as follows:

The Southwest corner of claim is located 4900 feet WEST and 5280 feet North of a brass cap permanent survey monument located at the southeast corner of Section 13, Township 20 North, Range 15 West, GSRB&M

DATED and POSTED on the ground this 21 day of JANUARY, 2018

LOCATOR

Nick Barr
Nick Barr

Agent for:

Pershing Resources

200 S. Virginia St., 8th Floor

Reno, Nevada 89501

AHC450536

MINING CLAIM MAP

Lode (X) Placer ()

← 1 mile →

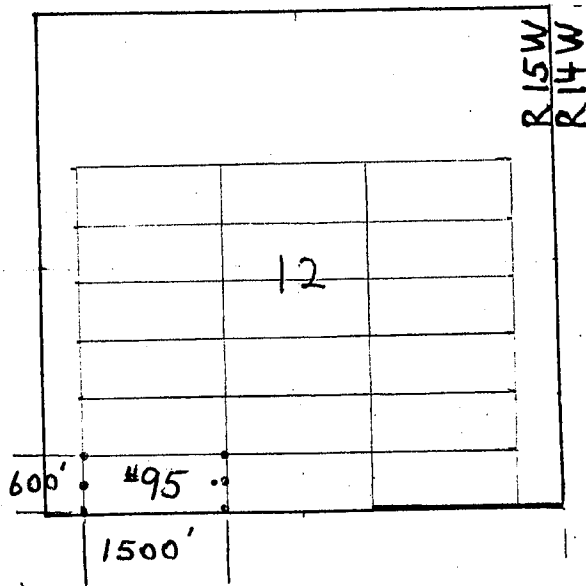

Scale: 1" = 2000 feet

1. The above map depicts the Mohave # 95 mining claim, which is located in Section (s) 12, Township 20 North, Range (s), 15, West, Gila and Salt River Base and Meridian, Mohave County, Arizona.
2. The type of corner and location monuments used are as follows:
2" x 2" x 4 ft wooden posts.
3. The bearings and distances in degrees and feet between claim corners are as depicted on the map.

2
After recording return to:

Pershing Resources
200 S. Virginia St., 8th Floor
Reno, Nevada 89501

FEE# 2018006190

OFFICIAL RECORDS
OF MOHAVE COUNTY
KRISTI BLAIR,
COUNTY RECORDER



02/08/2018 11:24 AM Fee: \$10.00

PAGE: 1 of 2

LOCATION NOTICE for LODE MINING CLAIM

Notice Is Hereby Given that the Mohave # 96
lode mining claim has been located by Nick Barr
whose current mailing address is; P.O. Box 6688
Apache Junction, Arizona 85178

BLM
date
stamp

RECEIVED
2018 APR 19 P 1:
PHOENIX, ARIZONA

The general course of this claim is EAST-WEST, and is situated in Mohave County, AZ. This claim is 1500 feet in length and 600 feet in width. This claim runs from the location monument, on which this location notice is posted, approximately 20 feet in a WEST direction to the west end line and 1480 feet in an EAST direction to the East end line. This claim is marked by six monuments, one at each corner and one at the center of each end line of the claim.

The location monument on which this notice is posted is situated within Section 12 Township 20 North, Range 15 West, Gila Salt River Base and Meridian, Arizona and this claim encompasses portions of the following quarter sections (s), Township (s), and Range (s) SW 1/4 SE 1/4 Section 12 Township 20 North, Range 15 West, Gila Salt River Base and Meridian, AZ.

The locality of this claim, with reference to some natural object or permanent monument and additional information (if any) concerning its locality are as follows:

The Southwest corner of claim is located 3400 feet WEST and 5280 feet North of a brass cap permanent survey monument located at the southeast corner of Section 13, Township 20 North, Range 15 West, GSRB&M

DATED and POSTED on the ground this 21 day of JANUARY, 2018

LOCATOR Nick Barr

Nick Barr
Agent for:
Pershing Resources
200 S. Virginia St., 8th Floor
Reno, Nevada 89501

AHC450537

MINING CLAIM MAP

Lode (X) Placer ()

← 1 mile →

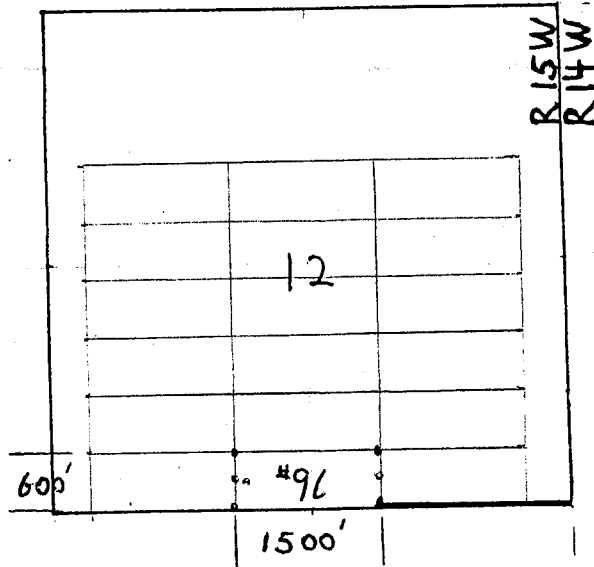

13
Scale: 1" = 2000 feet

1. The above map depicts the Mohave # 96 mining claim, which is located in Section (s) 12, Township 20 North, Range (s), 15, West, Gila and Salt River Base and Meridian, Mohave County, Arizona.
2. The type of corner and location monuments used are as follows:
2" x 2" x 4 ft. wooden posts.
3. The bearings and distances in degrees and feet between claim corners are as depicted on the map.

RUN TIME: 12:48 PM

DEPARTMENT OF INTERIOR
BUREAU OF LAND MANAGEMENT

RUN DATE: 04/26/2018
Page 1 of 1

Input Parameters for Geographic Report with Land

System Id = CR

Admin State = AZ

Geo State =

Casetype Begins With

Case Disp Txt = AUTHORIZED, CANCELLED, EXPIRED, PENDING, REJECTED, VOID, WITHDRAWN

Mer Twp Rng =

Section =

Mtrs = 14 0200N 0140W 018, 14 0200N 0140W 019, 14 0200N 0140W 999, 14 0200N 0150W 012, 14 0200N 0150W 999

Commodity =

Commodity Txt =

Pending Org =

Pend Org Decode =

Total Rows Returned: 13

NO WARRANTY IS MADE BY BLM FOR USE OF THE DATA
FOR PURPOSES NOT INTENDED BY BLM

RUN TIME: 12:48 PM

Adm State: AZ

UNITED STATES DEPARTMENT OF INTERIOR
BUREAU OF LAND MANAGEMENT
GEOGRAPHIC REPORT WITH LAND
Sorted by Serial Number

RUN DATE: 04/26/2018

Page 1 of 2

Serial Number: AZA 013138PT

Total Case Acres: 24,649.070

<u>Casetype</u>	<u>Case Disp</u>	14	0200N	0140W	<u>Sect</u>	<u>Sur Typ</u>	<u>Sur Num</u>	<u>Suff</u>	<u>Subdivision</u>	<u>Act Pend</u>
220100	AUTHORIZED				019	ALIQ			NENE,SESW,NWSE,S2SE;	

Serial Number: AZA 018820

Total Case Acres: 10.000

<u>Casetype</u>	<u>Case Disp</u>	14	0200N	0140W	<u>Sect</u>	<u>Sur Typ</u>	<u>Sur Num</u>	<u>Suff</u>	<u>Subdivision</u>	<u>Act Pend</u>
286203	AUTHORIZED				018	ALIQ			E2SW;	
						LOTS			1-4;	
					019	LOTS			1-4;	

Serial Number: AZA 022698PT

Total Case Acres: 11,747.600

<u>Casetype</u>	<u>Case Disp</u>	14	0200N	0150W	<u>Sect</u>	<u>Sur Typ</u>	<u>Sur Num</u>	<u>Suff</u>	<u>Subdivision</u>	<u>Act Pend</u>
221006	AUTHORIZED				012	ALIQ			N2,SW,N2SE,SWSE,N2SESE;	
						ALIQ		1	SWSESE;	

Serial Number: AZA 029135

Total Case Acres: 22.560

<u>Casetype</u>	<u>Case Disp</u>	14	0200N	0150W	<u>Sect</u>	<u>Sur Typ</u>	<u>Sur Num</u>	<u>Suff</u>	<u>Subdivision</u>	<u>Act Pend</u>
281001	AUTHORIZED				012	MNR		1	E2E2NE;	

Serial Number: AZA 033143

Total Case Acres: 2.400

<u>Casetype</u>	<u>Case Disp</u>	14	0200N	0140W	<u>Sect</u>	<u>Sur Typ</u>	<u>Sur Num</u>	<u>Suff</u>	<u>Subdivision</u>	<u>Act Pend</u>
281001	AUTHORIZED				018	ALIQ			E2NW,NE;	
						LOTS			1;	

RUN TIME: 12:48 PM

Adm State: AZ

UNITED STATES DEPARTMENT OF INTERIOR
BUREAU OF LAND MANAGEMENT
GEOGRAPHIC REPORT WITH LAND
Sorted by Serial Number

RUN DATE: 04/26/2018

Page 2 of 2

Serial Number: AZA 033582

Total Case Acres: 10.200

<u>Casetype</u>	<u>Case Disp</u>	14	0200N	0140W	<u>Sect</u>	<u>Sur Typ</u>	<u>Sur Num</u>	<u>Suff</u>	<u>Subdivision</u>	<u>Act Pend</u>
281001	AUTHORIZED				018	ALIQ LOTS MNR			SENW,N2SE; 1,2; SWSWNE;	

Serial Number: AZA 037286

Total Case Acres: 3.208

<u>Casetype</u>	<u>Case Disp</u>	14	0200N	0140W	<u>Sect</u>	<u>Sur Typ</u>	<u>Sur Num</u>	<u>Suff</u>	<u>Subdivision</u>	<u>Act Pend</u>
285003	AUTHORIZED				019	LOTS			3,4;	

Serial Number: AZAR 0002061

Total Case Acres: 46.160

<u>Casetype</u>	<u>Case Disp</u>	14	0200N	0140W	<u>Sect</u>	<u>Sur Typ</u>	<u>Sur Num</u>	<u>Suff</u>	<u>Subdivision</u>	<u>Act Pend</u>
285002	AUTHORIZED				018	ALIQ LOTS			E2SW; 1-4;	Y Y
					019	ALIQ LOTS			NENW; 1-4;	Y Y

MOHAVE COUNTY
KINGMAN FIELD OFFICE

T 21N
R 14W | R 13W

[illegible]

MDS 394 SE
395 SW

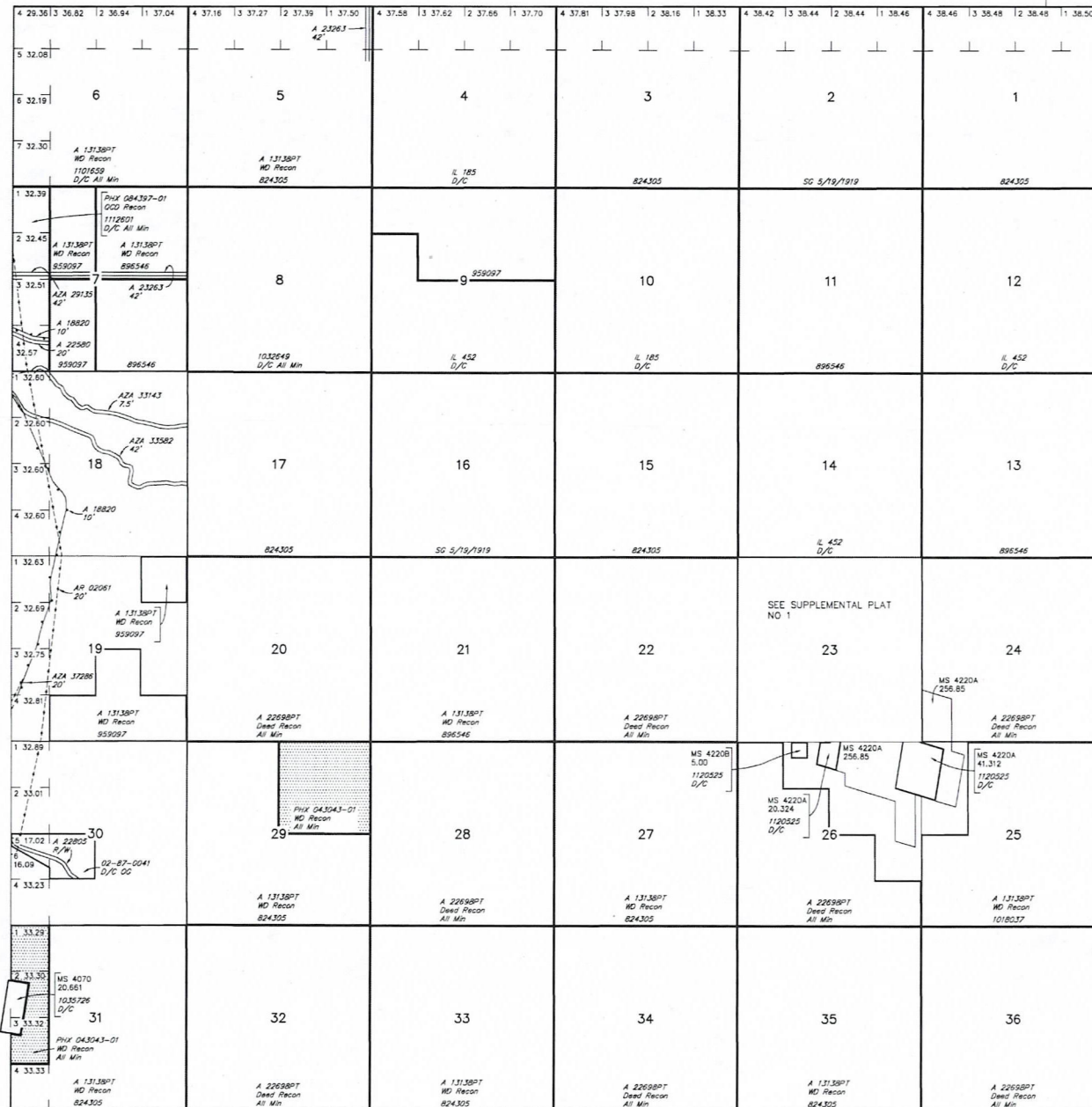

Lat	35°03'45"N
Long	113°42'55"W

SCALE in chains

WARNING STATEMENT
This plot is the Bureau's Record of Title, and should be used only as a graphic display of the township survey data. Records herein do not reflect title changes which may have been effected by lateral movements of rivers or other bodies of water. Refer to the cadastral surveys for official survey information.

CURRENT TO	NW	GSR Mer
8-17-2017	ACAD	T 20 N
		R 14 W

Extremely Urgent

This envelope is for use with the following services:

UPS Next Day Air®
UPS Worldwide ExpressSM
UPS 2nd Day Air®

Visit **theupsstore.com** or call **1-800-PICK-UPS®** (1-800-742-5877) to find a location near you.

Domestic Shipments

- To qualify for the Letter rate, UPS Express Envelopes may only contain correspondence, urgent documents, and/or electronic media, and must weigh 8 oz. or less. UPS Express Envelopes containing items other than those listed or weighing more than 8 oz. will be billed by weight.

International Shipments

- The UPS Express Envelope may be used only for documents of no commercial value. Certain countries consider electronic media as documents. Visit ups.com/importexport to verify if your shipment is classified as a document.
- To qualify for the Letter rate, the UPS Express Envelope must weigh 8 oz. or less. UPS Express Envelopes weighing more than 8 oz. will be billed by weight.

Note: Express Envelopes are not recommended for shipments of electronic media containing sensitive personal information or breakable items. Do not send cash or cash equivalent.

JOEL ADAMS
(646) 387-6859
THE UPS STORE #6514
163 AMSTERDAM AVE
NEW YORK NY 10023-5001

1.0 LBS LTR 1 0
SHIP WT: 1 LBS
DATE: 17 APR 2018

SHIP ATTN BUREAU OF LAND MANAGMENT
TO: US DEPARTMENT OF THE INTERIOR
STE 800
1 N CENTRAL AVE

PHOENIX AZ 85004-4427

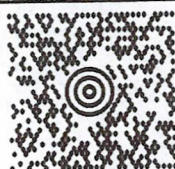

AZ 850 9-10



UPS NEXT DAY AIR SAVER 1P

TRACKING #: 1Z 0V0 937 13 4857 3279

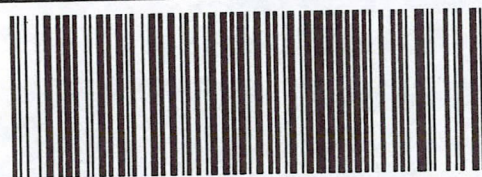

BILLING: P/P

REF #1: NJ

ISH 13.00H Z2P 450 97.5V 01/2018



SEE NOTICE ON REVERSE regarding UPS Terms, and notice of limitation of liability. Where allowed by law, shipper authorizes UPS to act as forwarding agent for export control and customs purposes. If exported from the US, shipper certifies that the commodities, technology or software were exported from the US in accordance with the Export Administration Regulations. Diversion contrary to law is prohibited. 8000 012 0318

Apply shipping documents on this side.

Do not use this envelope for:

UPS Ground
UPS Standard
UPS 3 Day Select®
UPS Worldwide Expedited®

Visit **theupsstore.com** to learn more about our Print & Business Services.

100% Recycled fiber
80% Post-Consumer



International Shipping Notice — Carriage hereunder may be subject to the rules relating to liability and other terms and/or conditions established by the Convention for the Unification of Certain Rules Relating to International Carriage by Air (the "Warsaw Convention") and/or the Convention on the Contract for the International Carriage of Goods by Road (the "CMR Convention"). These commodities, technology or software were exported from the U.S. in accordance with the Export Administration Regulations. Diversion contrary to U.S. law prohibited.

an 100 years
arcel Service.



01880250709 07/15 United Parcel Service

The UPS Store®



Express envelope

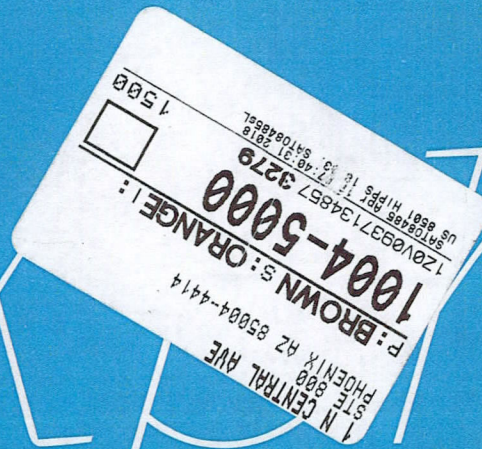

Print & Business Services • theupsstore.com • theupsstorefranchise.com